

COMPOSE®

3 & 4 Circuit Top Feed Module

Installation Instructions

Tools Required

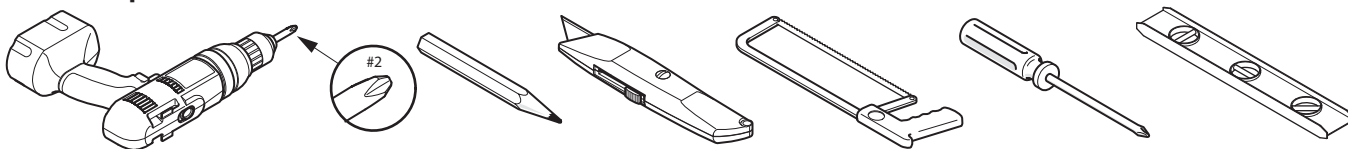

WARNING: do not electrically interconnect modular power distribution systems powered from two different power feed units. This poses a **SHOCK HAZARD** to service personnel and will cause **RISK OF FIRE** due to excessive circulating currents.

WARNING: Power to all branch circuits **MUST REMAIN DISCONNECTED** during installation or removal of electrical components and raceway covers to avoid **SHOCK HAZARDS**.

NOTE: Connections of this modular power distribution component **MUST** be done by a licensed electrician, who must control the size and loading of each branch circuit. The person or group installing Haworth products is responsible for complying with all applicable building and electrical code requirements.

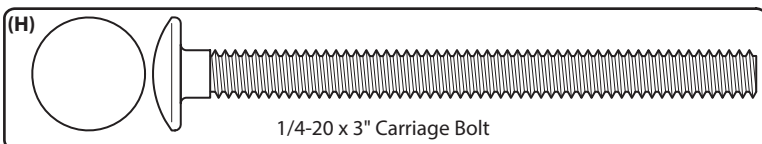
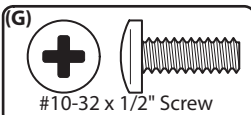
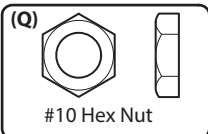
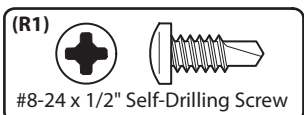
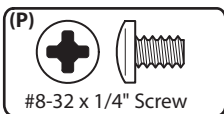
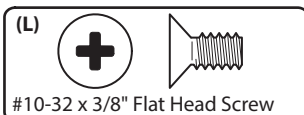
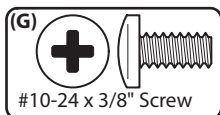
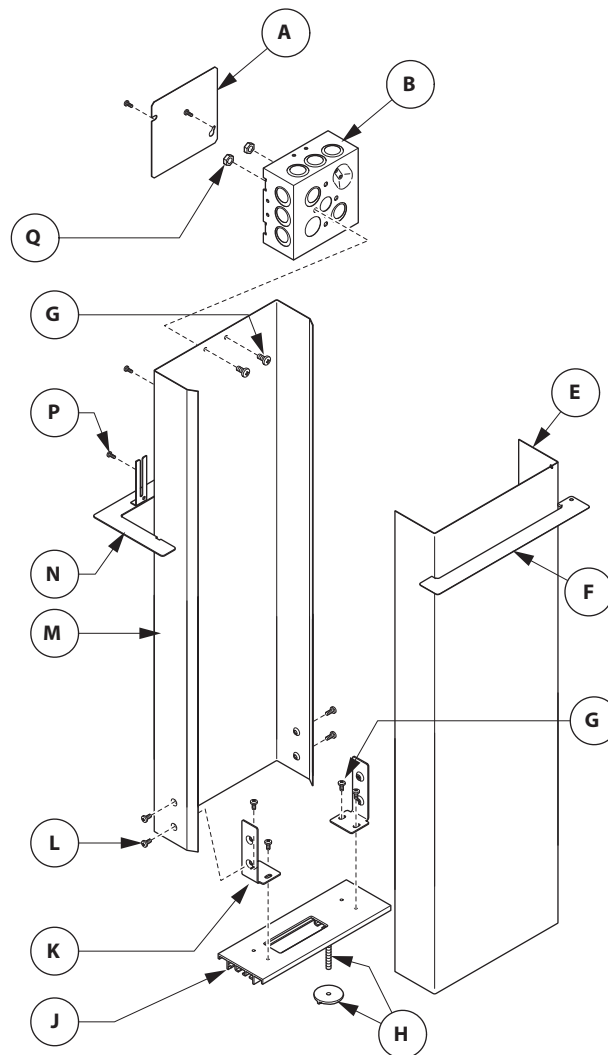

COMPOSE CONNECTIONS - PARTS

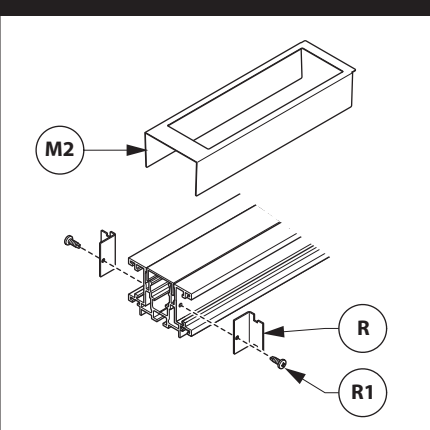

CUSTOMER SERVICE PHONE: 1-800-426-8562

HAWORTH®

E.C.O. No: 298-749

Page: 1 of 4

Part No: 7029-9617

Rev: 2

1

Modify and install top trim (R)

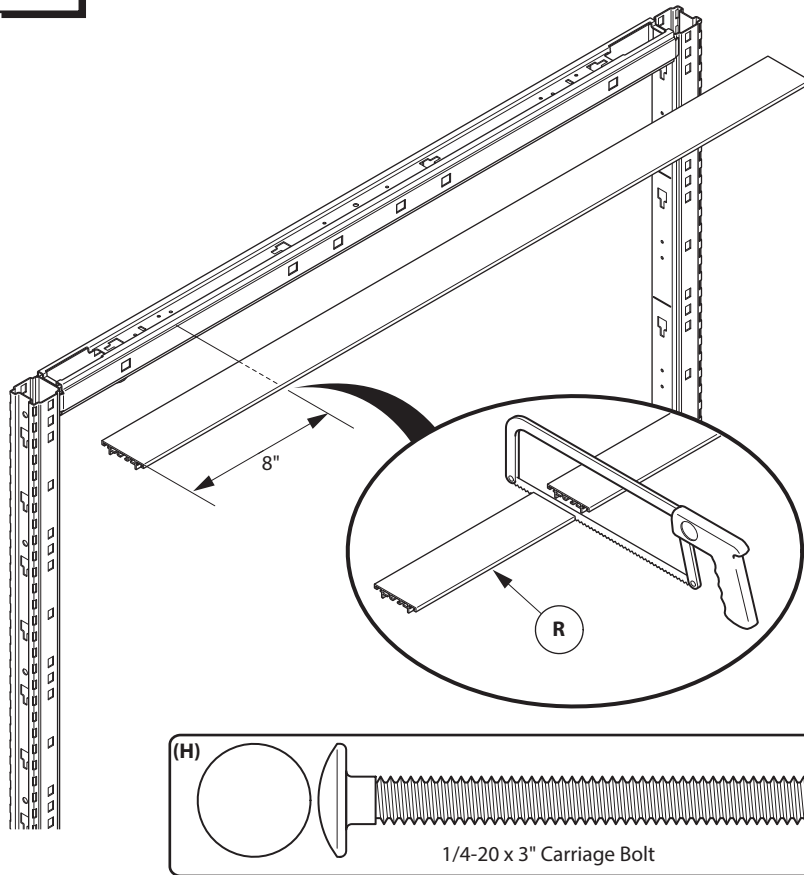

2

Install top feed trim (J) & brackets (K)

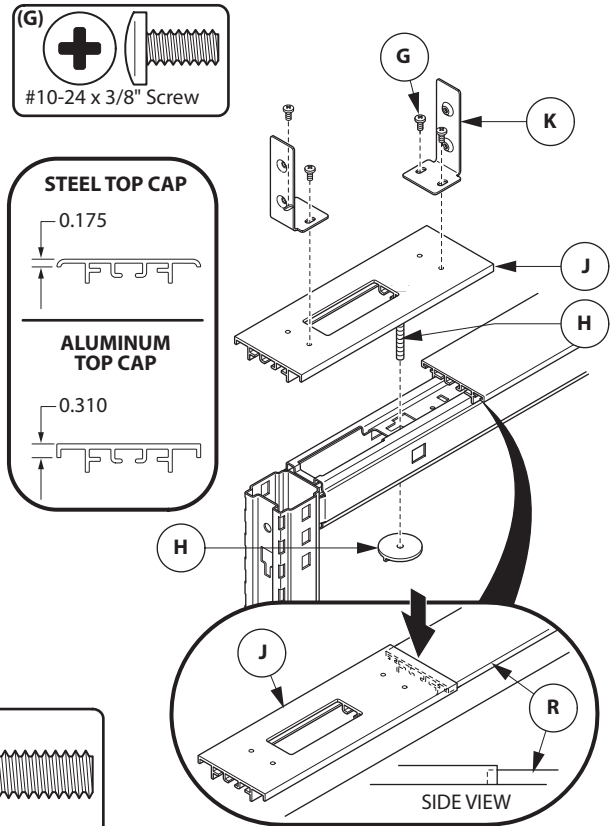

3

Install inner cover (M)

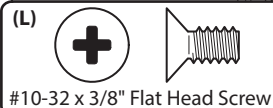
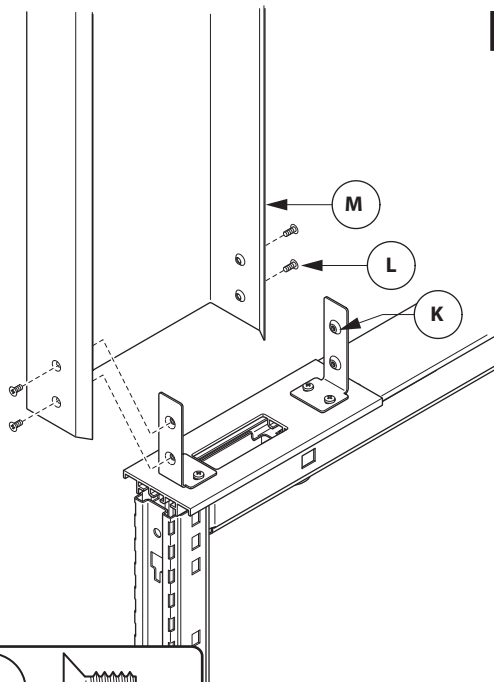

OR

COMPOSE CONNECTIONS - TRIM COVER

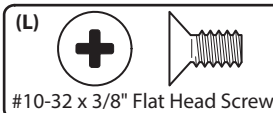
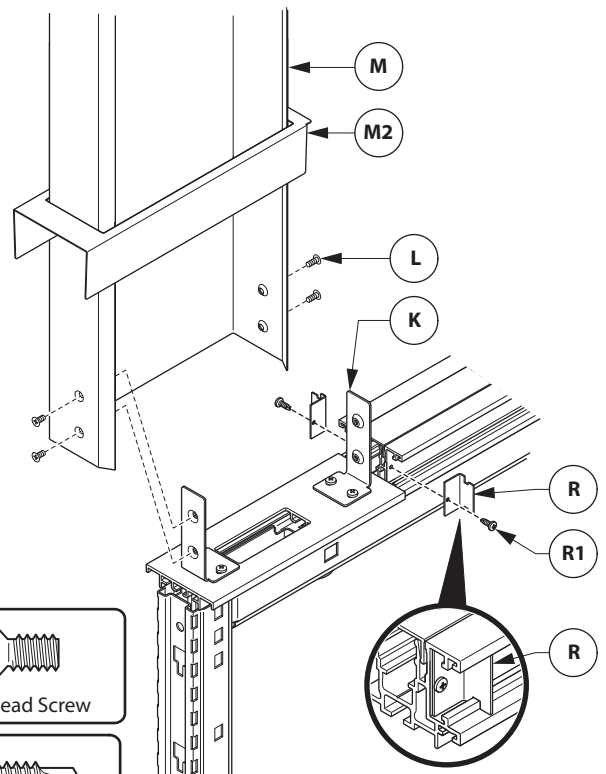

CUSTOMER SERVICE PHONE: 1-800-426-8562

HAWORTH®

E.C.O. No: 298-749

Page: 2 of 4

Part No: 7029-9617

Rev: 2

4

Plumb cover (M) and locate and cut a hole in ceiling tile

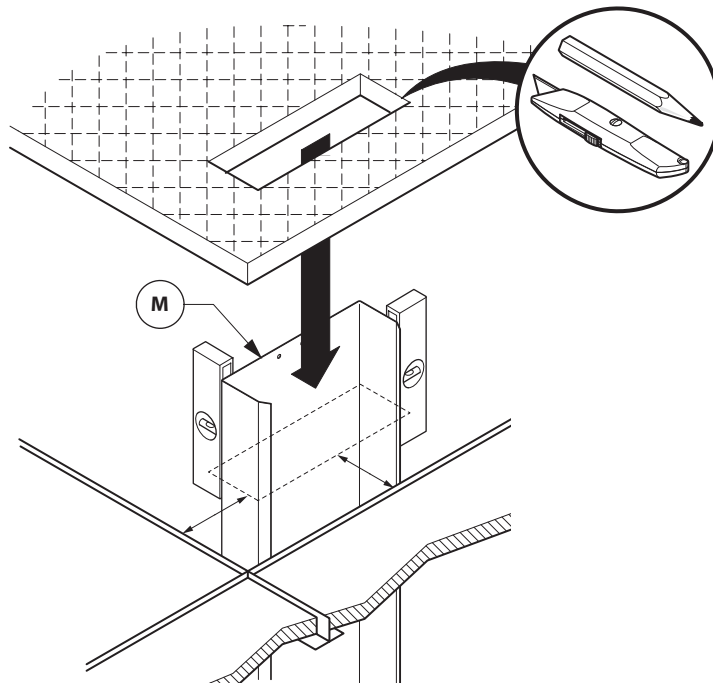

5

Install outer cover (E)

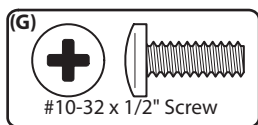
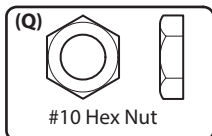
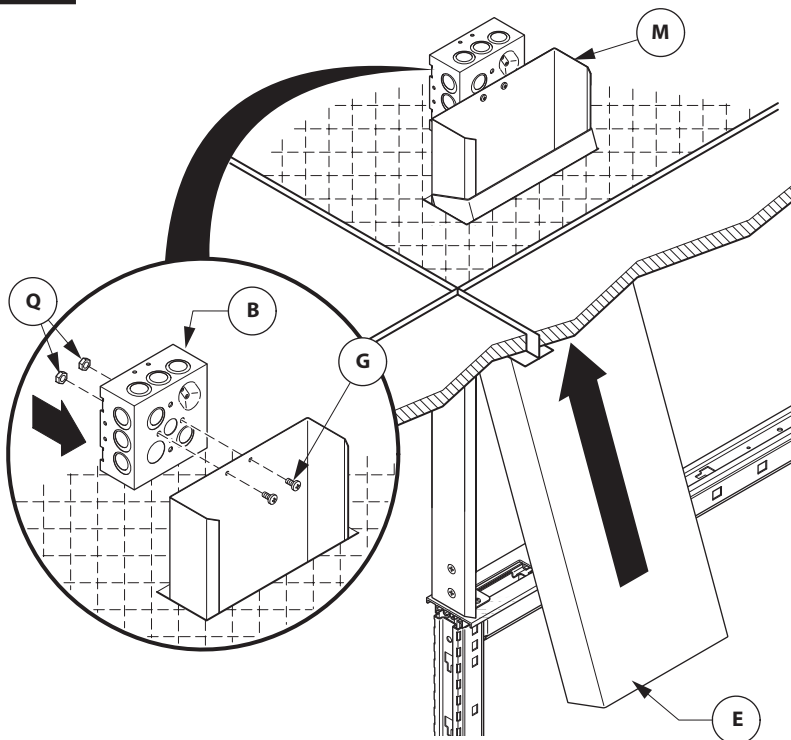

6

Install ceiling bezel (N)

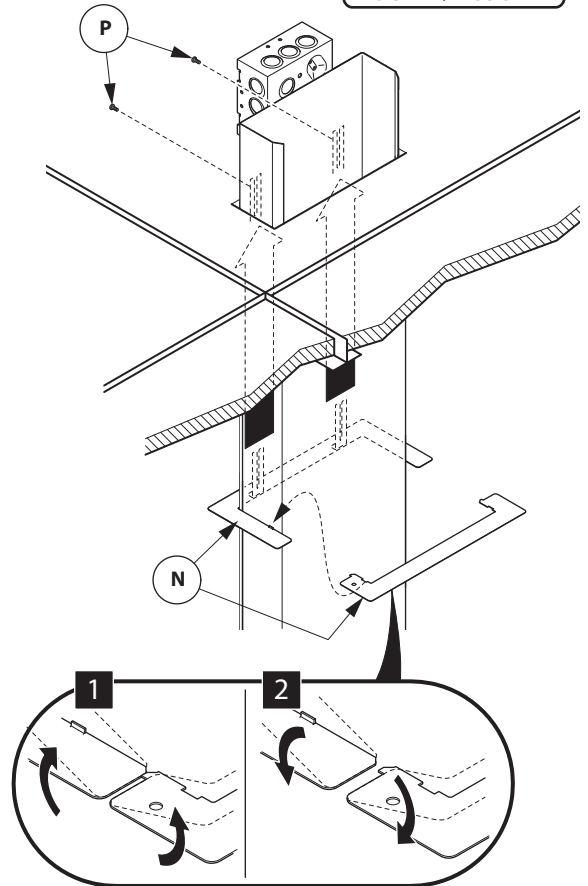
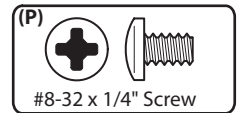

CUSTOMER SERVICE PHONE: 1-800-426-8562

HAWORTH®

E.C.O. No: 298-749

Page: 3 of 4

Part No: 7029-9617

Rev: 2

7

Install electrical box cover (A)

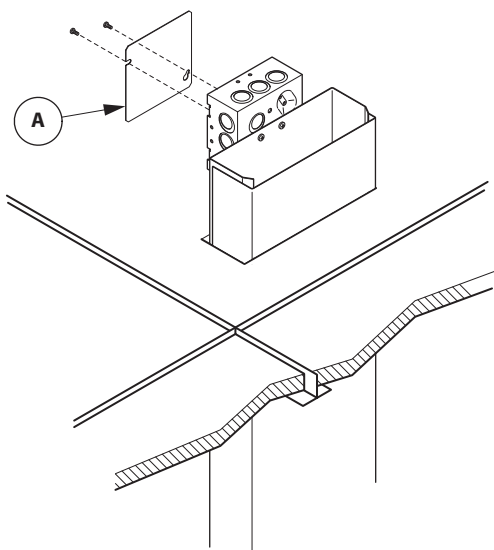

8

Cut & install grommet (R)

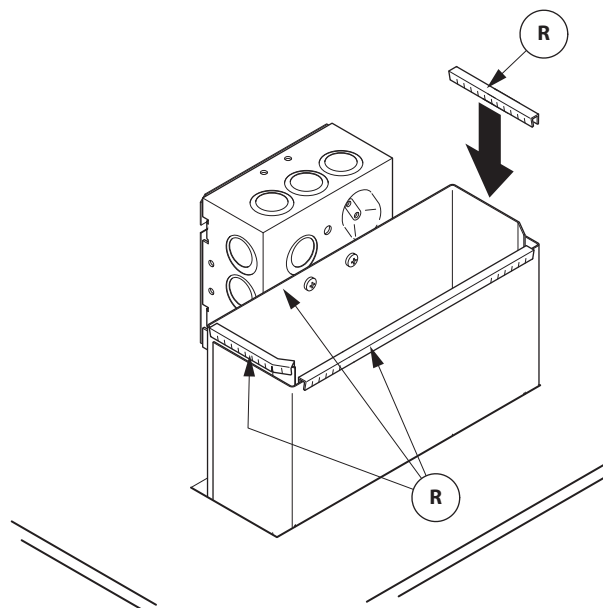

9

Tie top feed (K) to building

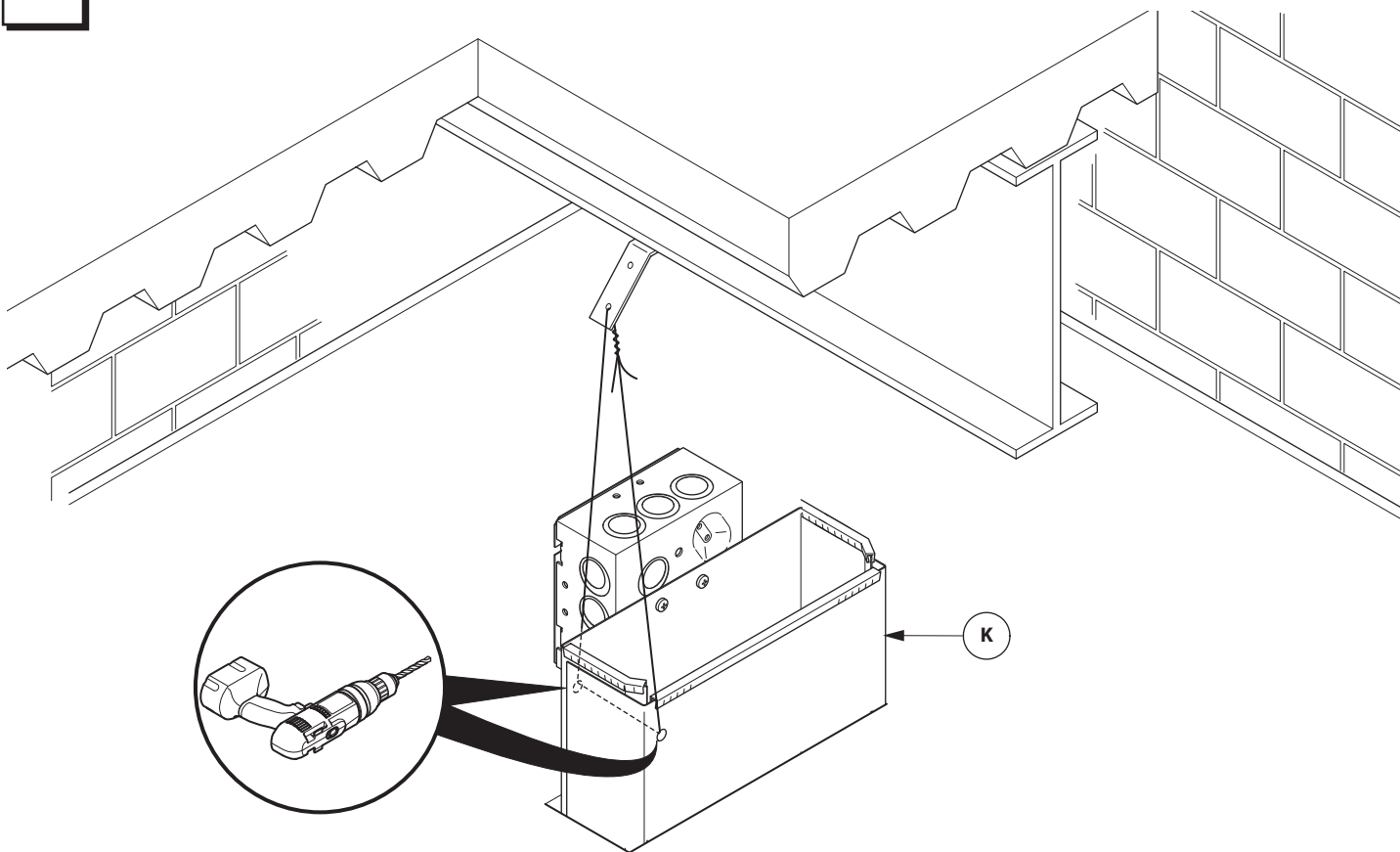

CUSTOMER SERVICE PHONE: 1-800-426-8562

HAWORTH®

E.C.O. No: 298-749

Page: 4 of 4

Part No: 7029-9617

Rev: 2