



**Freestanding
Mobile Screen / Marker Board**
Installation Instructions

*Panel móvil / Tarjeta de la etiqueta
de plástico independiente
Instrucciones de Instalación*

*Paravent mobile / Panneau de
marqueur autoporteur
Instructions d'installation*

Tools Required

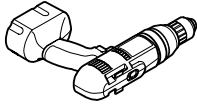

T-30 Torx Bit

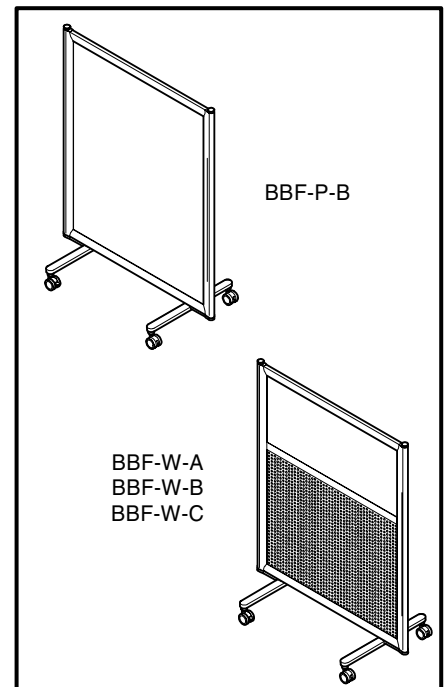
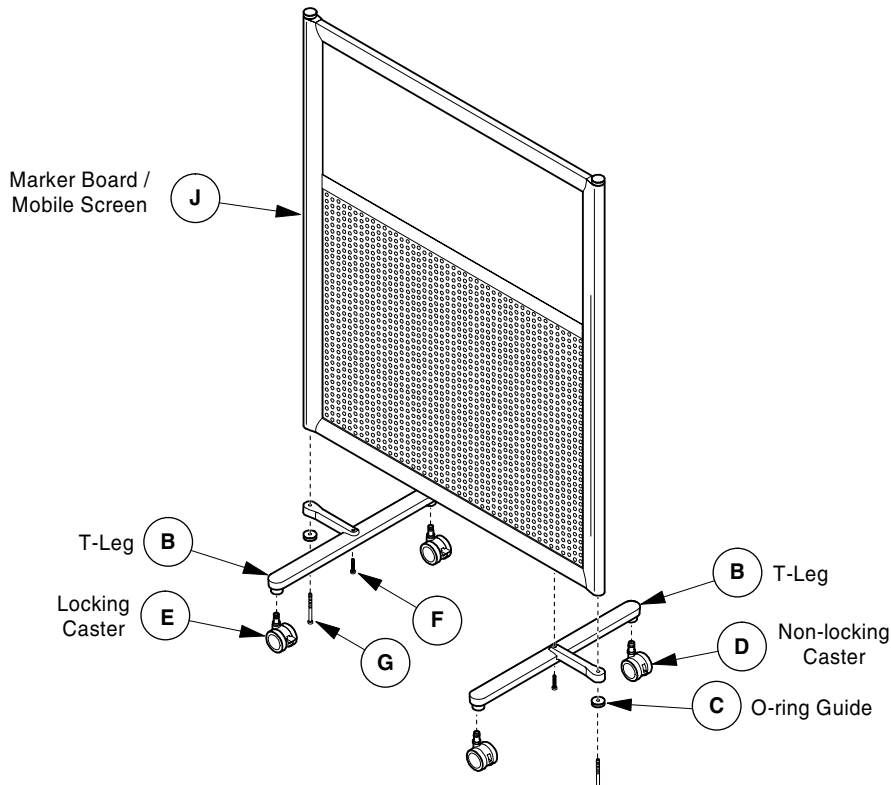
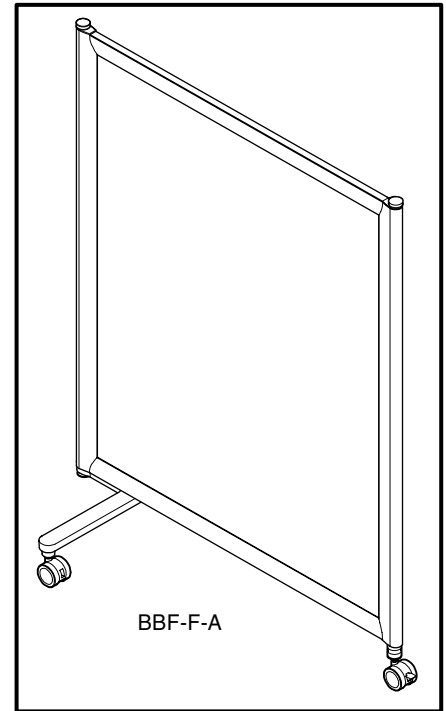
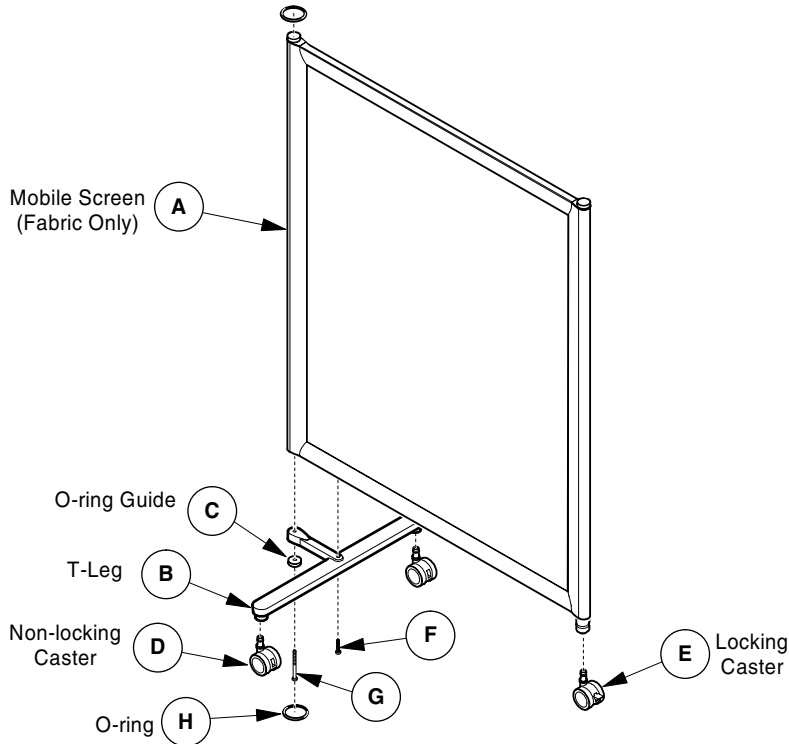

CUSTOMER SERVICE PHONE: 1-800-426-8562

HAWORTH®

E.C.O. No: 299-066

Page: 1 of 3

Part No: 7021-7866

Rev: E

1

Install T-Leg(s) (B)

Instale las patas en T (B)

Installer la ou les pattes en T (B).

(G)

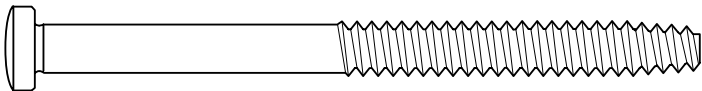

1/4-20 x 3.50 SCREW

(F)

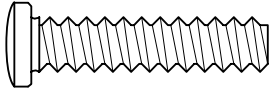

1/4-14 x 1.25 SCREW

NOTE! NOTA! REMARQUE!

Fabric covered mobile screen uses (1) T-leg on bottom of frame.

La pantalla móvil recubierta de tela lleva una (1) pata en T en la parte de abajo del armazón.

L'écran mobile recouvert de tissu s'installe avec un pied en T à la base du cadre.

CAUTION! PRECAUCIÓN! MISE EN GARDE!

Do not over tighten screws.

No apriete en exceso los tornillos.

Éviter de trop serrer les vis.

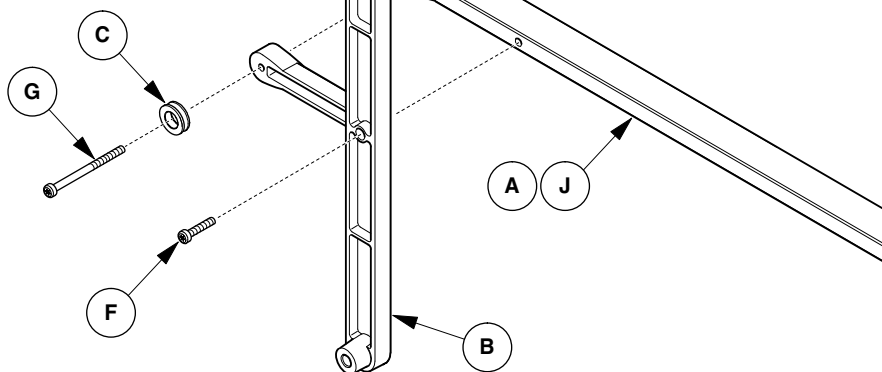

2

Install Casters (D & E)

Instale las ruedas (D y E)

Installer les roulettes (D et E)

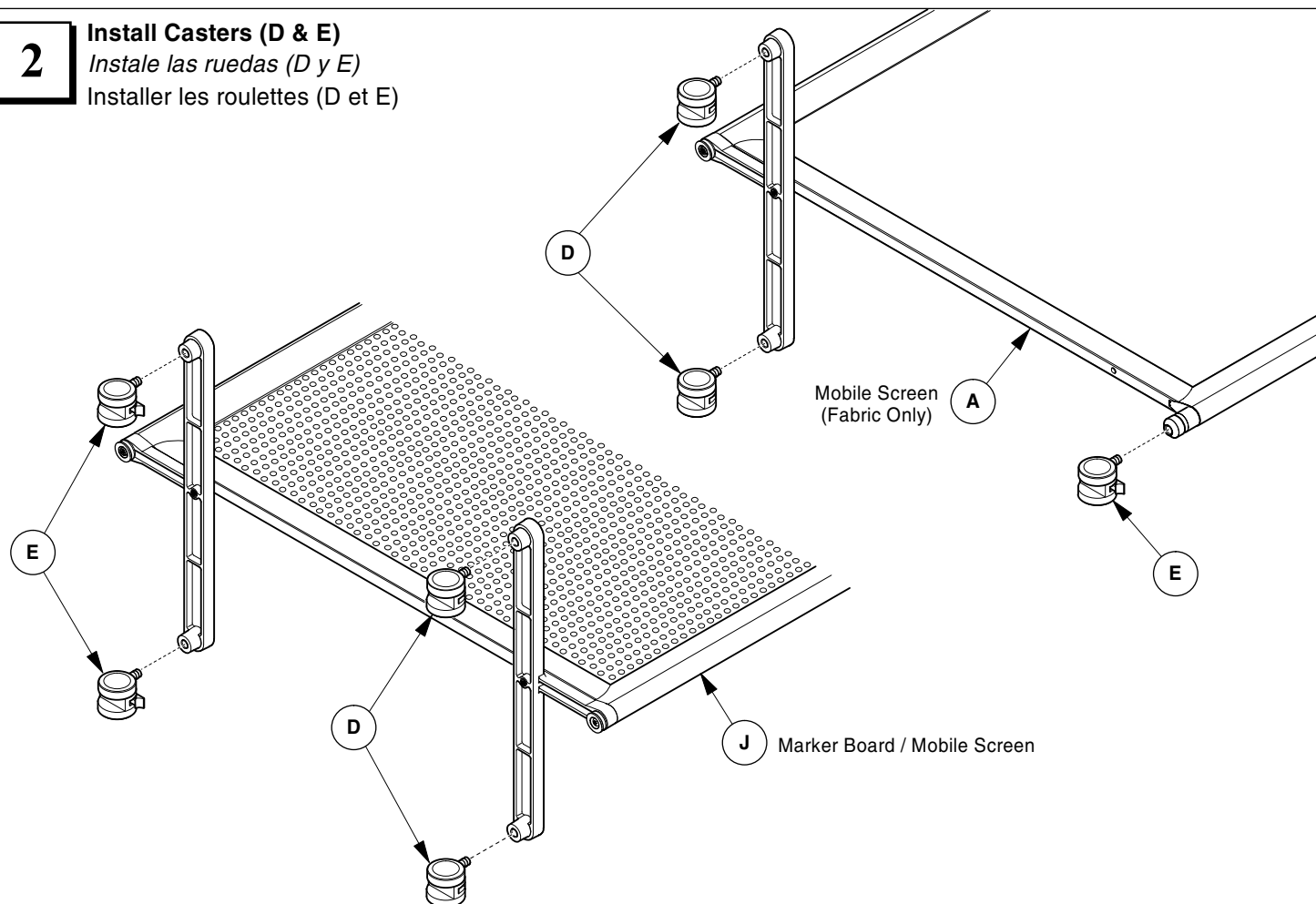

CUSTOMER SERVICE PHONE: 1-800-426-8562

HAWORTH®

E.C.O. No: 299-066

Page: 2 of 3

Part No: 7021-7866

Rev: E

Optional / Opcional / Facultatif

3

Install o-ring (G) for multiple screens and marker boards

Instale el anillo tórico (G) para varias pantallas y tableros para marcador.

Installer des anneaux toriques si plusieurs panneaux ou tableaux blancs sont joints.

NOTE! NOTA! REMARQUE!

Twist o-ring when connecting multiple screens and marker boards.

Tuerza el anillo tórico cuando conecte varias pantallas y tableros para marcador.

Pour connecter plusieurs panneaux ou tableaux blancs, tourner les anneaux toriques en formant un huit.

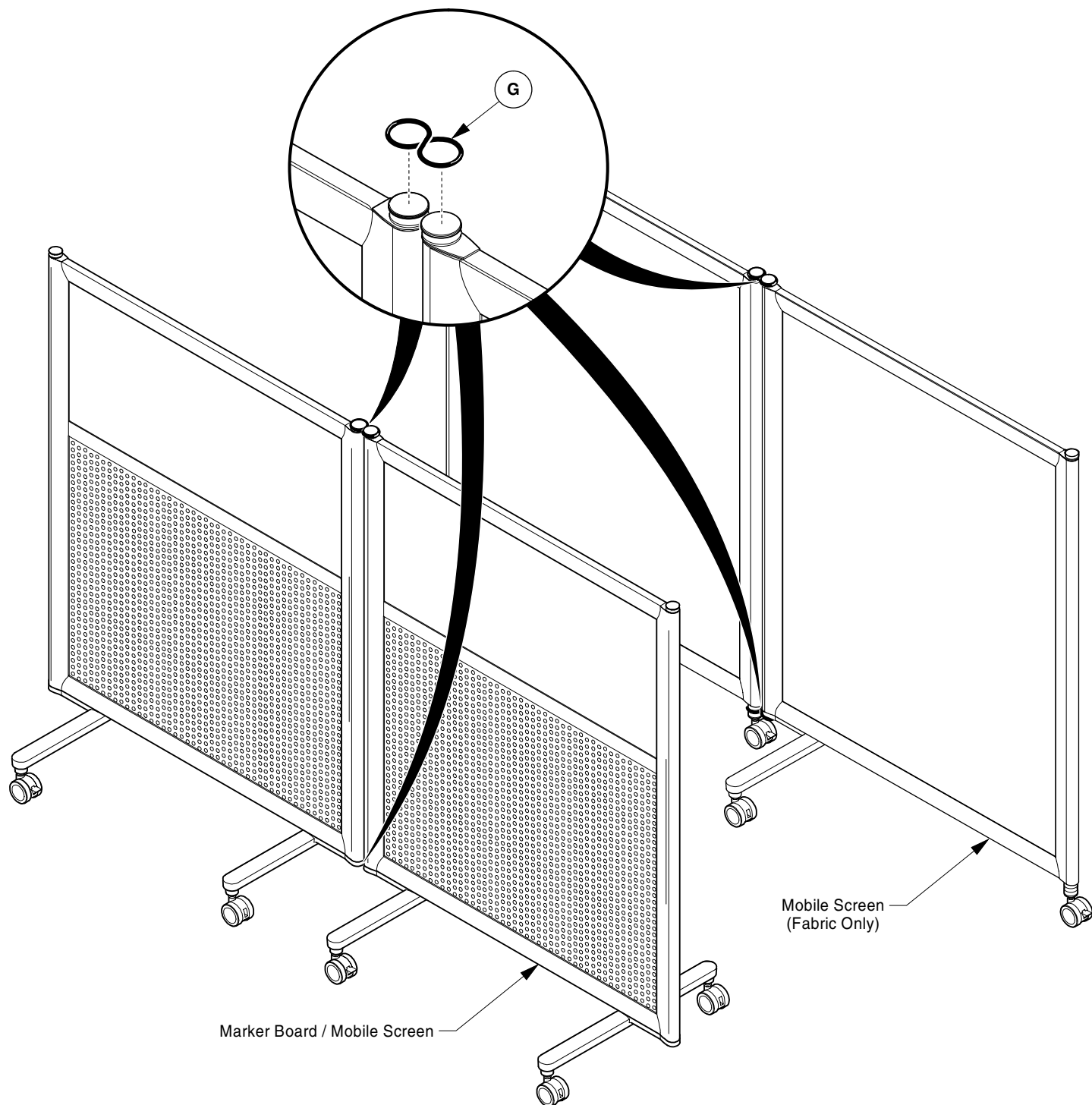

CUSTOMER SERVICE PHONE: 1-800-426-8562

HAWORTH®

E.C.O. No: 299-066

Page: 3 of 3

Part No: 7021-7866

Rev: E