

**CHICAGO RACE POWER POLE
Installation Instructions**

Assume: Beam is installed with all electrical wiring and receptacle assemblies in place, properly connected, and communication raceway covers have been removed. On this center post, the 2" plastic plug has been removed, but the top cover disk is in place. The ceiling tiles have been removed for access.

NOTE: To be field wired under authority of permit.

1. Remove screw and raceway cover on either side of post or beam midpoint selected for the power pole providing access to the conductors and the center post power access hole, in the lower power raceway.

NOTE: If power pole needs to be shortened, remove electrical mounting bracket by removing (2) screws. Cut to fit. Drill (2) 9/64" holes in the top of the power pole, using the electrical mounting bracket as a template for communication quadrant(s). Cut upper segments separately.

2. Remove the top cover disk, and push onto power pole bottom. If power pole has communication quadrant(s), mark outline of quadrant segment(s) on the top cover disk. Carefully cut top cover disk to provide communication wiring access.
3. Fish conductors up through the center post power access hole, and then through the power pole.
4. Keep tension on the conductors extending from the top of power pole. Slide power pole over center post, and secure set screw after proper alignment.
5. Using the ceiling flange as a template, cut the ceiling tile to clear the power pole. Position upper communications pole segments on the power pole as required. Slide ceiling flange onto power pole and secure by drilling 9/64" holes through slot into communication channel and installing sheet metal screws (not supplied). Install ceiling tile.

6. Prepare electrical mounting bracket and ceiling entry communications junction box for installation by mounting necessary fittings, boxes and conduit.
7. Fish conductors through electrical mounting bracket and mount to power pole with screw. Mount ceiling entry communication junction box to each quadrant by sliding the mounting tabs fully into the quadrant top and secure screws.
8. Replace covers and secure with screws.
9. Connect conductors to building wiring by approved methods and close box as required.
10. Install communication wiring. Snap in communication raceway cover onto beam and lower communication pole extension onto disc. Install remaining communication pole segment. Install remaining ceiling tiles. Secure cover, with screws, to ceiling entry communication junction box.

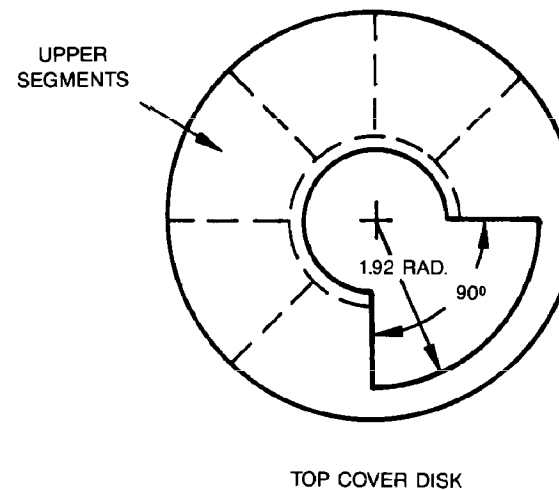
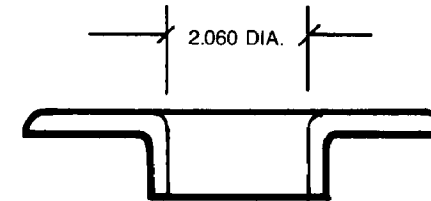

**NOTE: CONDUCTORS
ARE NOT SUPPLIED**

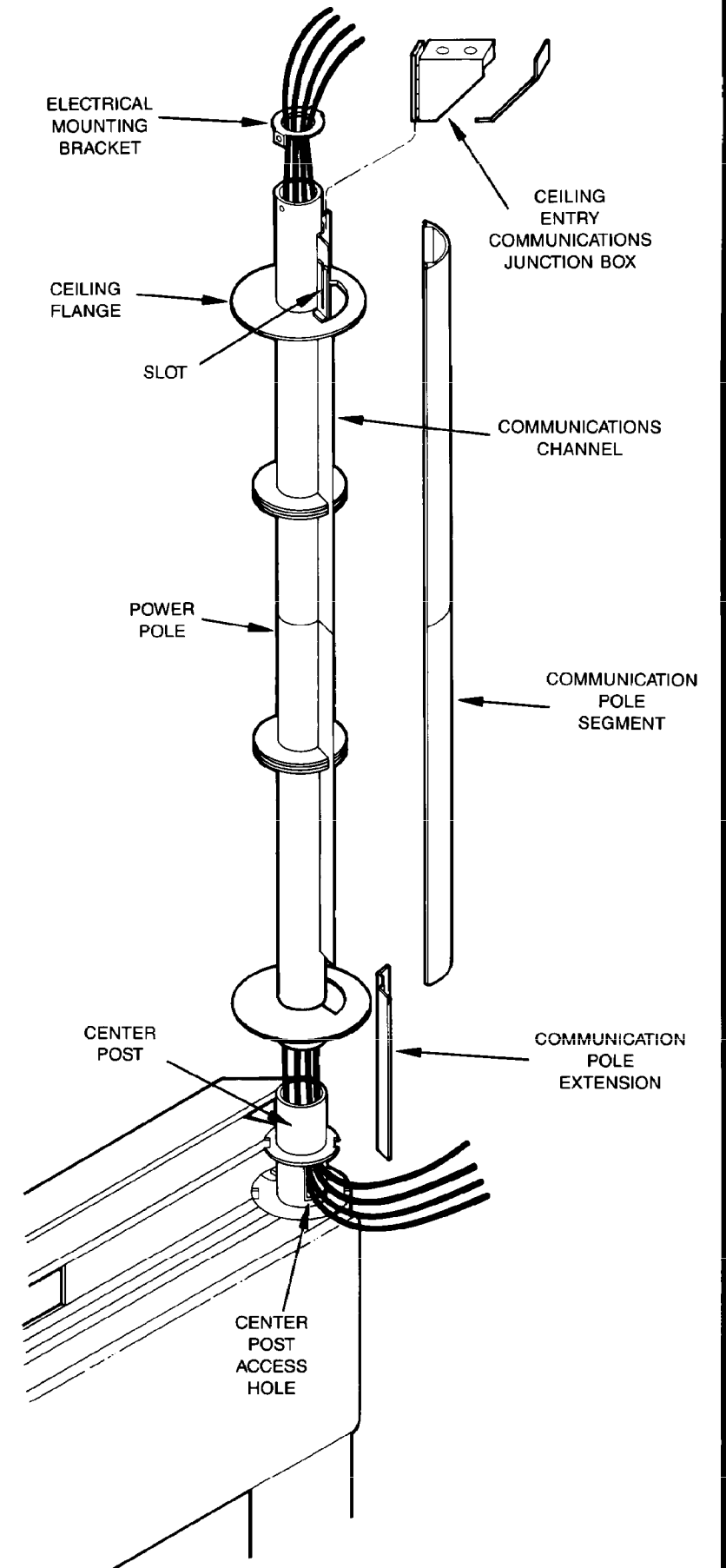

CUSTOMER SERVICE PHONE: 1-800-426-8562

Part No: 7021-6651

ECO No: 220-152

Page: 1 OF 1

Rev: A

HAWORTH