

PATTERNS®
Studio Table
Installation Instructions

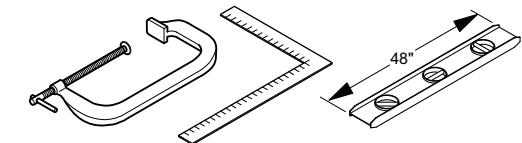

Tools Required

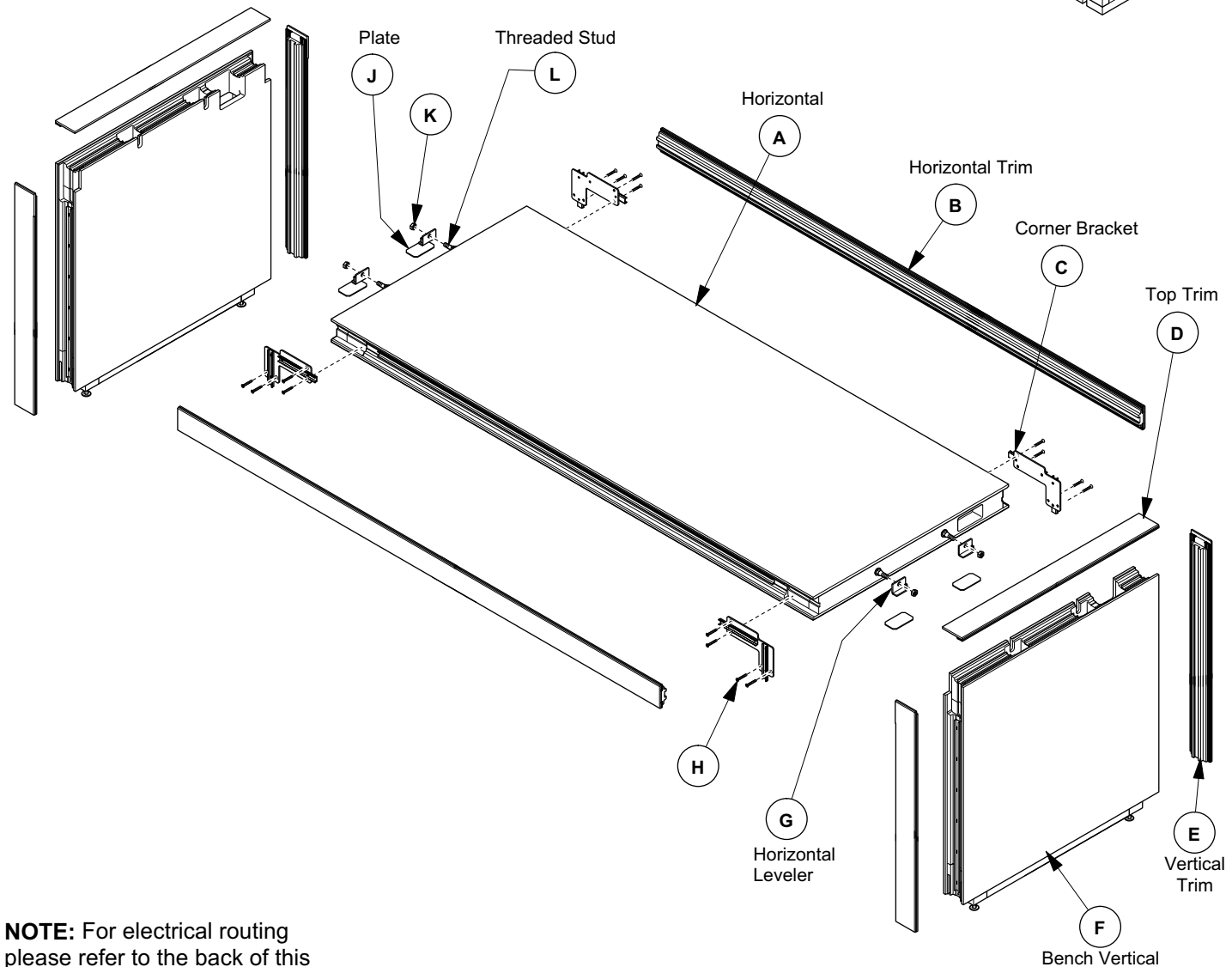

NOTE: For electrical routing please refer to the back of this instruction.

ELECTRICAL ASSEMBLY

Connection of panels to permanent wiring of building **MUST** be done by a licensed electrician who must control the size and loading of each branch circuit. The person or group installing HAWORTH products is responsible for complying with all NEC and local code requirements. In some localities it is also required that the electrician perform all electrical work including installation of receptacles and flexible connectors of the pre-wired electrical system. Check with your local jurisdiction for any restrictions in your area. See "PATTERNS Power Installation Instructions" which accompany electrical products.

CUSTOMER SERVICE PHONE: 1-800-426-8562

FOR POWER APPLICATIONS

1

Install base feed (S) and communications cables (S)

HORIZONTALS

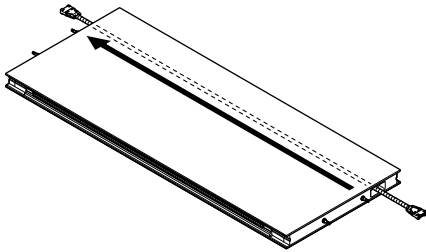

VERTICALS

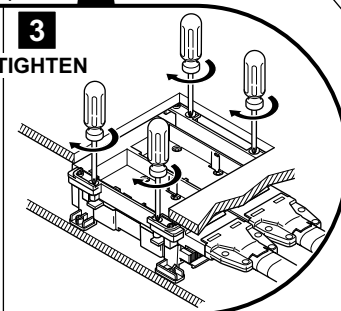
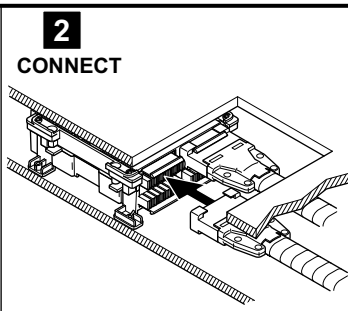
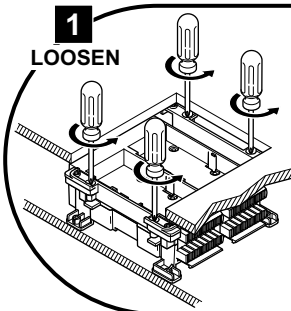
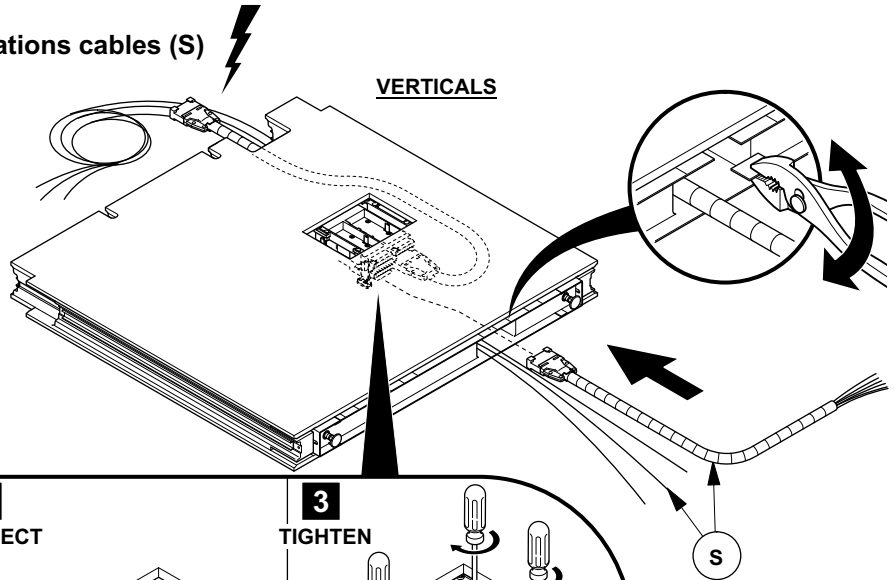

3 CIRCUIT WIRE DIAGRAM

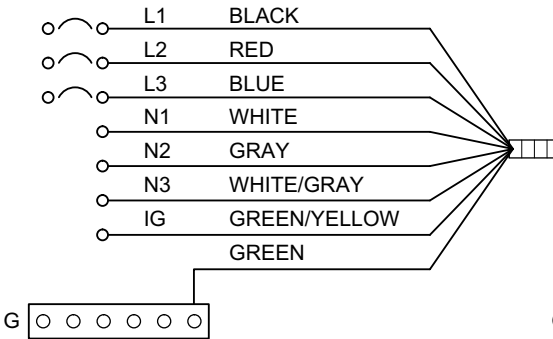

4 CIRCUIT WIRE DIAGRAM

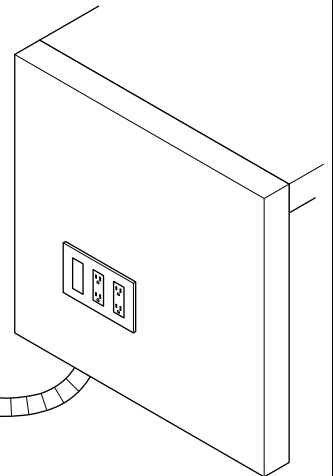
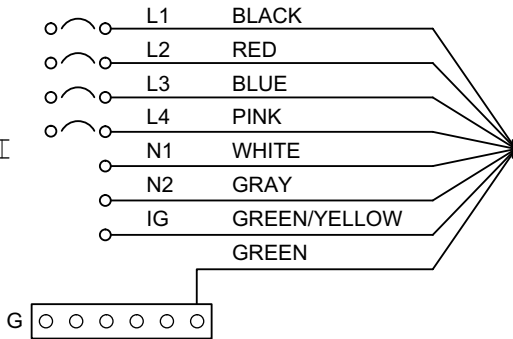

2

Clamp verticals (F) and level

NOTE: Adjust glides (P) to level verticals (F) before installing horizontals (A).

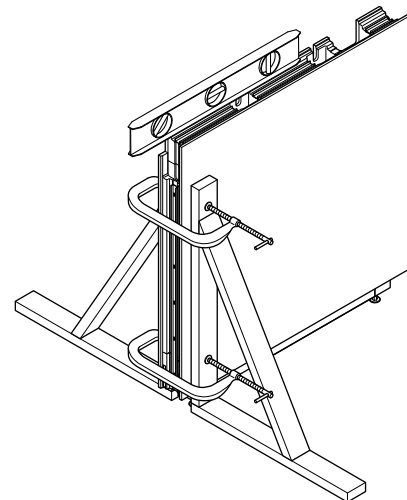
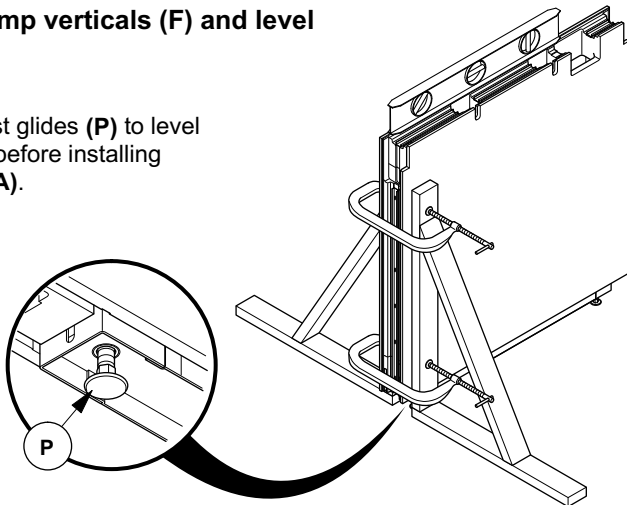

CUSTOMER SERVICE PHONE: 1-800-426-8562

FOR POWER APPLICATIONS

3 Route data cables and snap together harness

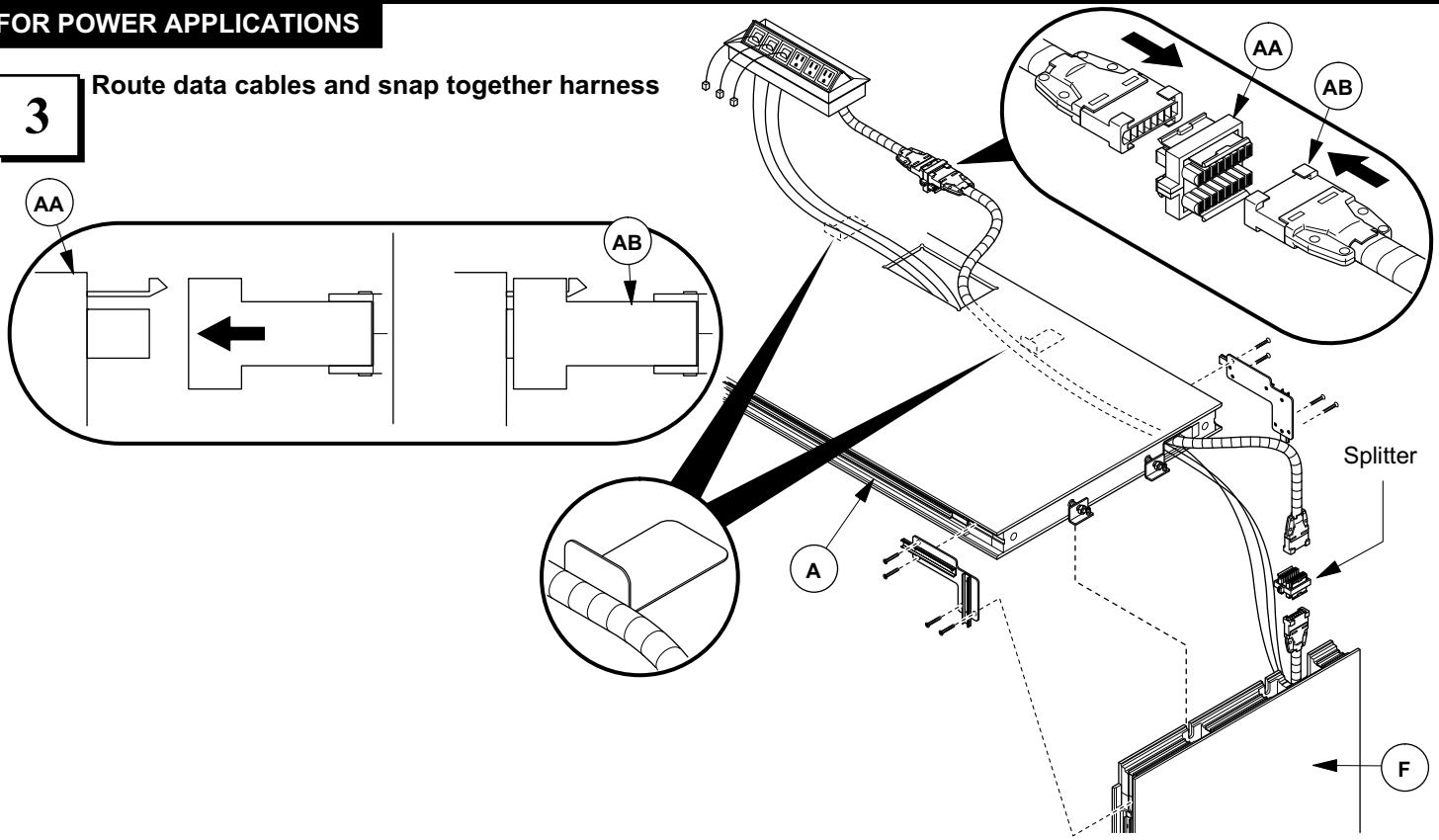

BASE FEED APPLICATIONS

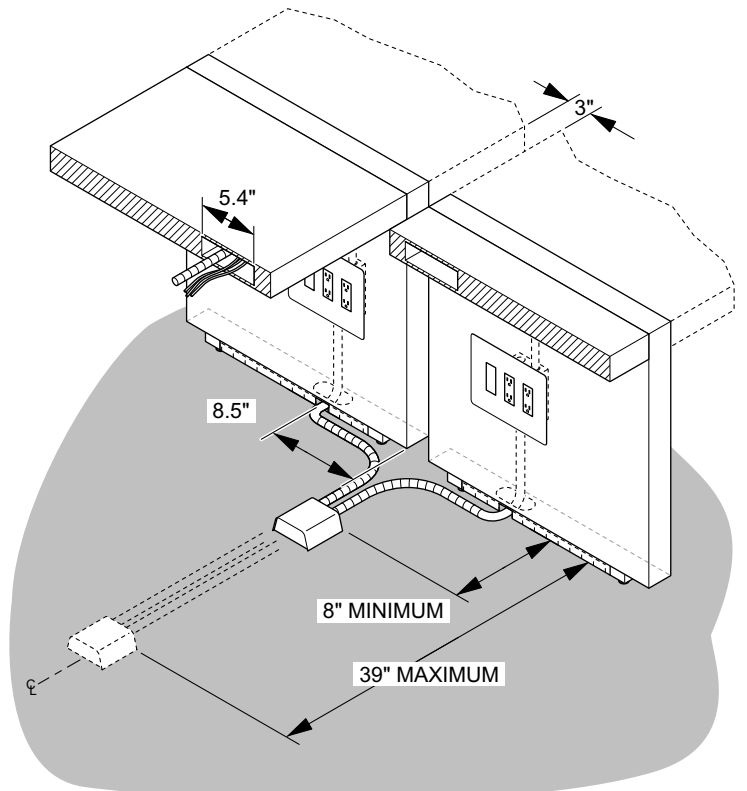
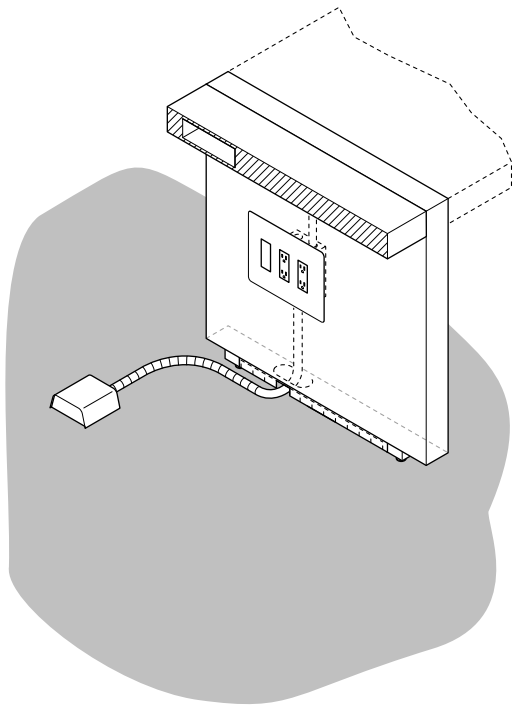

CUSTOMER SERVICE PHONE: 1-800-426-8562

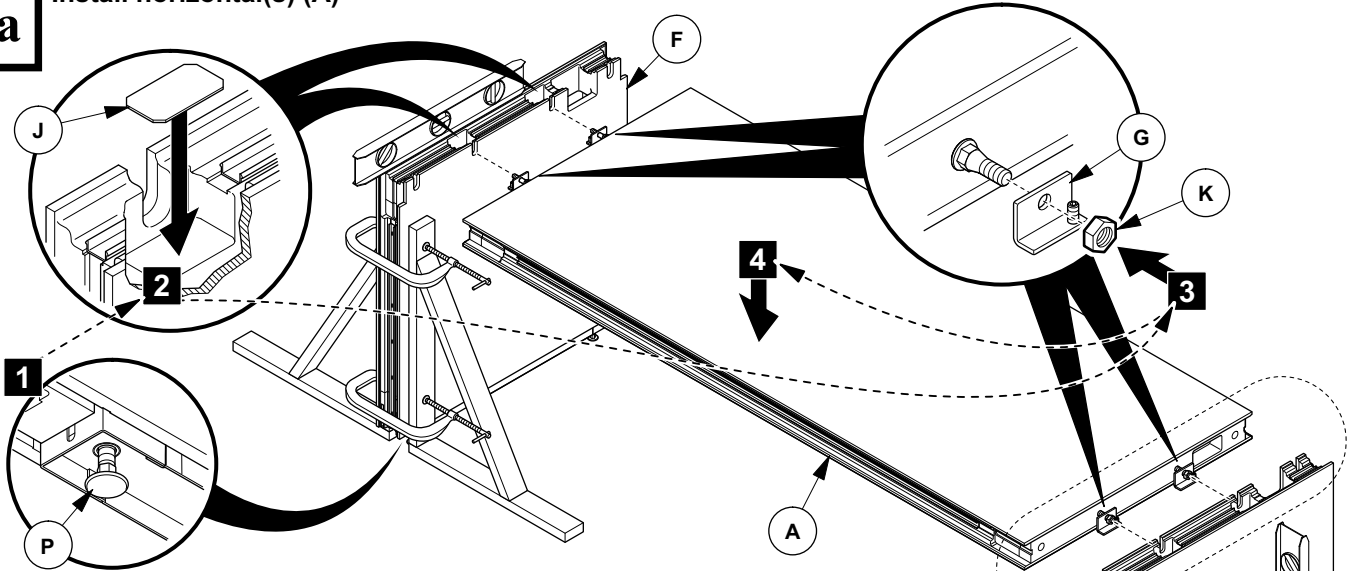
4a**Install horizontal(s) (A)**

NOTE: Adjust glides (P) to level verticals (F) before installing horizontals (A).

4b**Adjust horizontal leveler(s) (G)**

NOTE: Adjust horizontal levelers (G) until gage (M) is flush with horizontal (A).

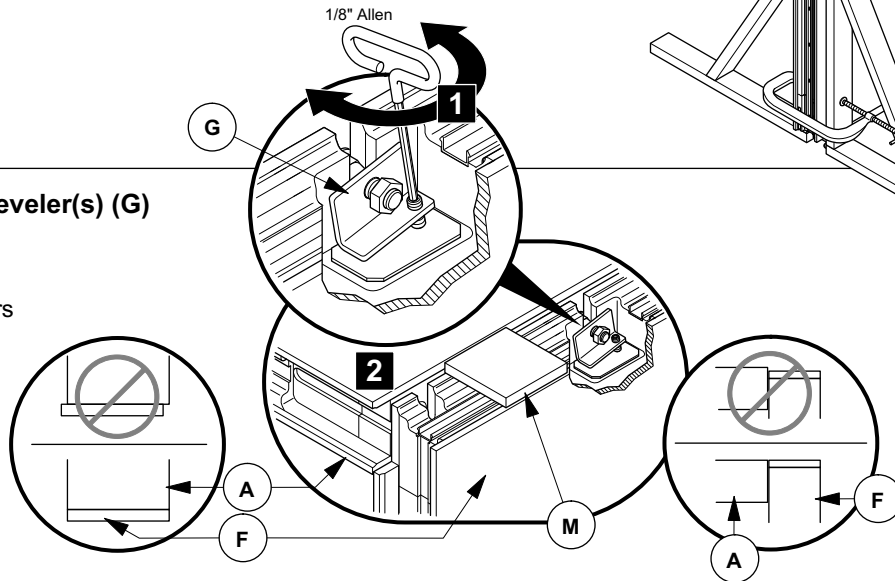
**5a****Install top trim (D) to check height**

NOTE: Use Top Trim (D) to verify proper horizontal height, if not adjust horizontal levelers (G).

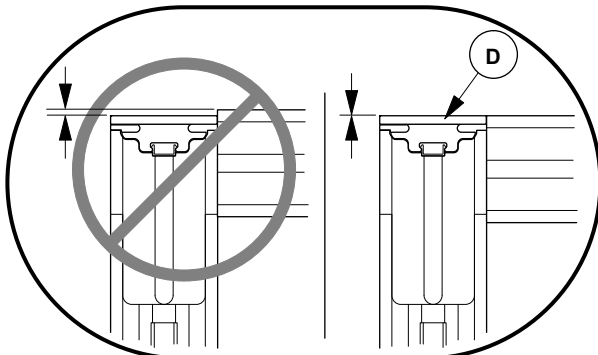
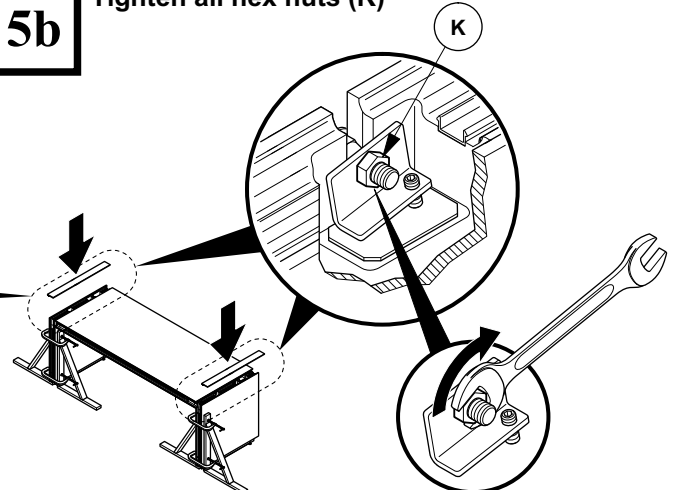
**5b****Tighten all hex nuts (K)**

CUSTOMER SERVICE PHONE: 1-800-426-8562

HAWORTH

E.C.O. No: 370-053

Page: 4 of 8

Part No: 7029-9800

Rev: A

FOR CENTER VERTICALS ONLY

6 Shim (N) so trim (D) fits

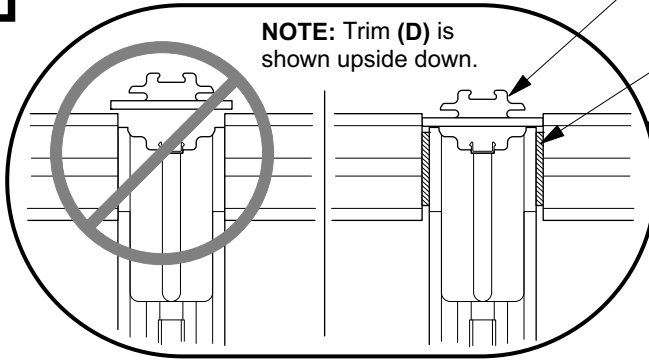

NOTE: Trim (D) is shown upside down.

NOTE: Shims (N) come in 3 thicknesses.

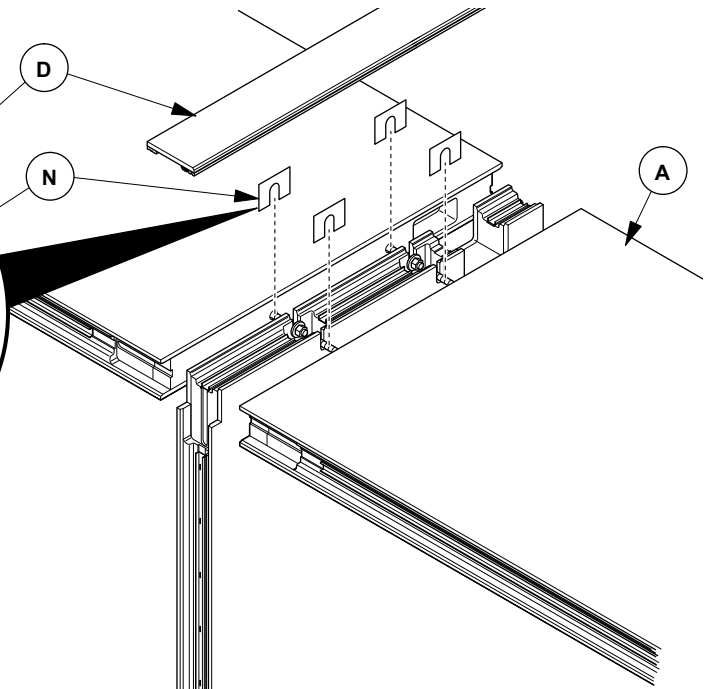
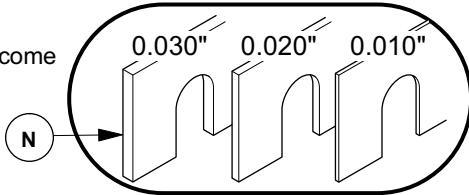

FOR CENTER VERTICALS ONLY

7 Install center bracket (C)

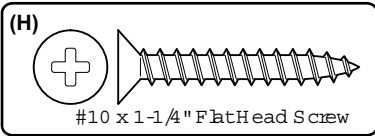

#10 x 1-1/4" Flat Head Screw

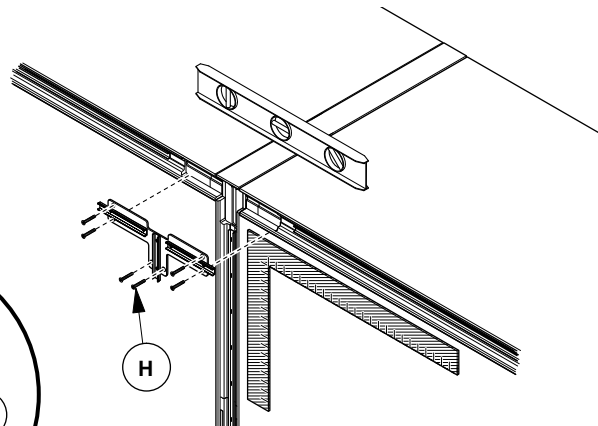
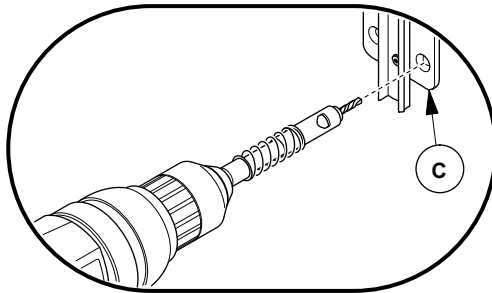

8 Install corner brackets (C)

NOTE: Readjust glides (P) to level horizontals and verticals before installing corner brackets

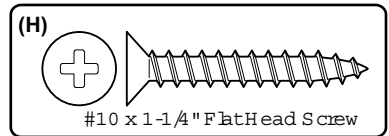

#10 x 1-1/4" Flat Head Screw

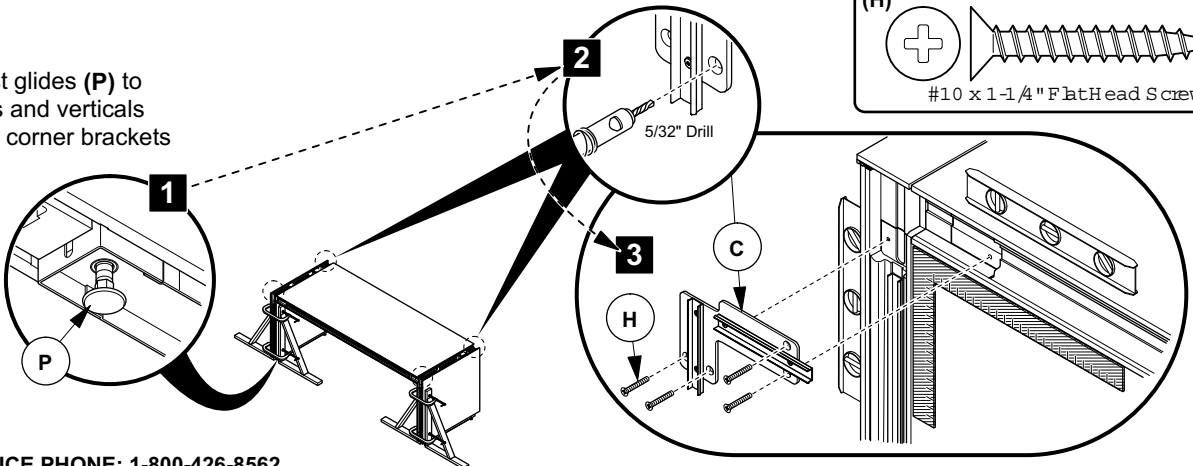

CUSTOMER SERVICE PHONE: 1-800-426-8562

9

Install trim

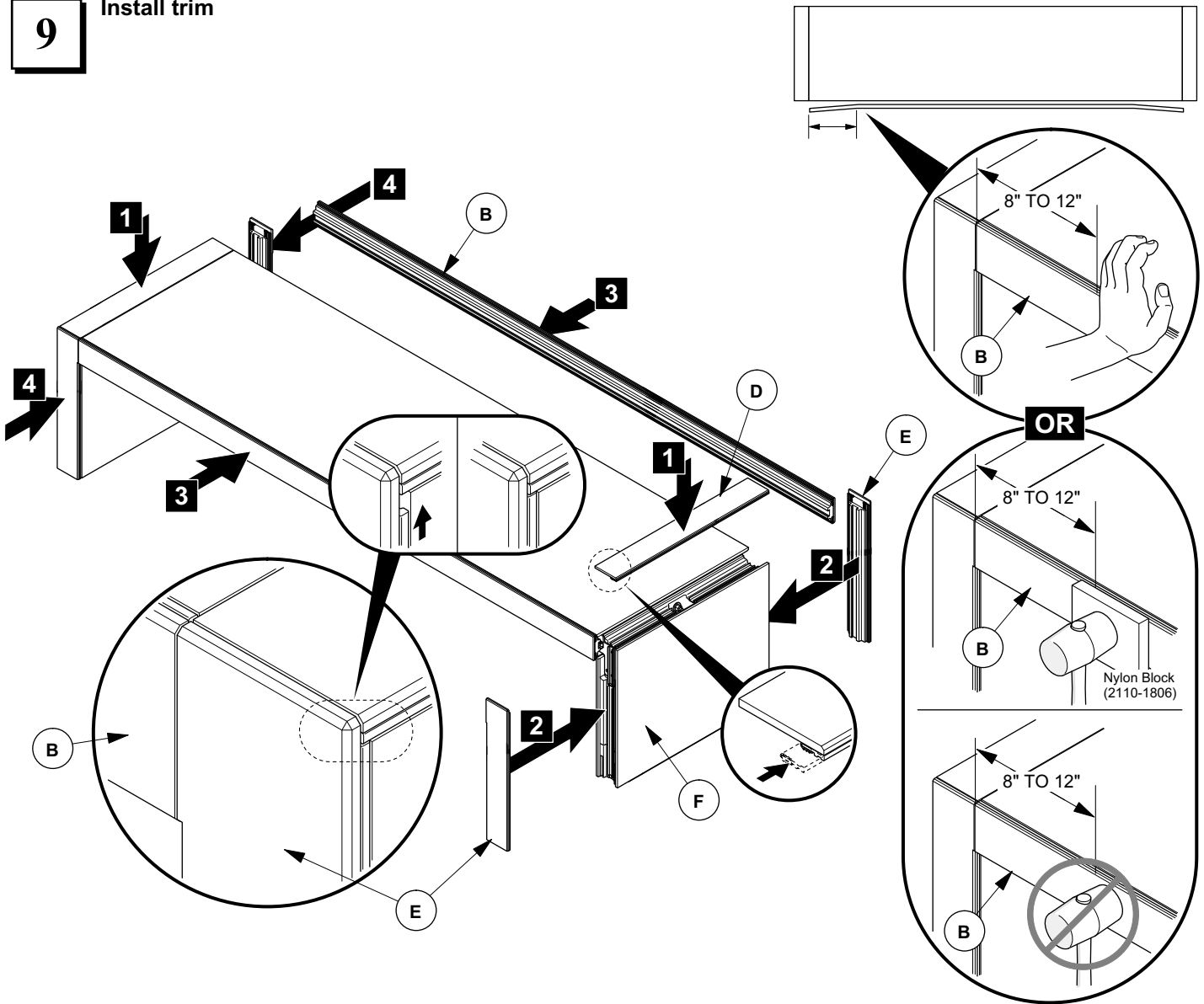

FOR CENTER VERTICALS ONLY

10

Install center trim (R)

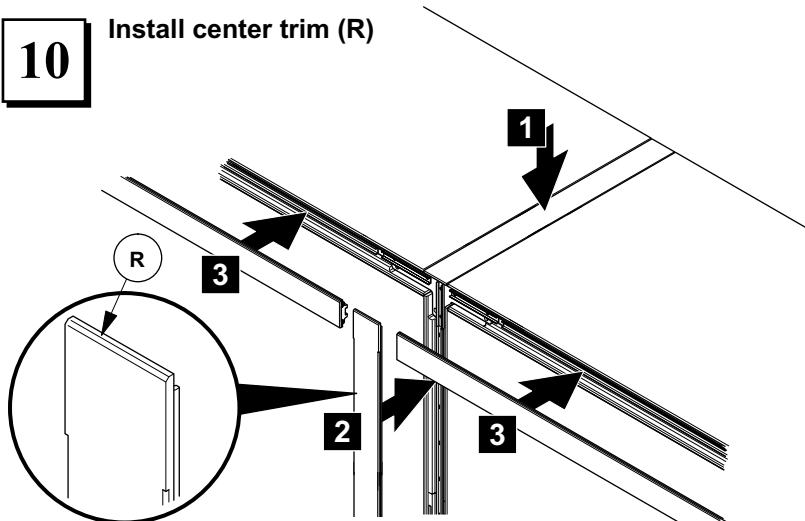

CUSTOMER SERVICE PHONE: 1-800-426-8562

TRIM REMOVAL

11

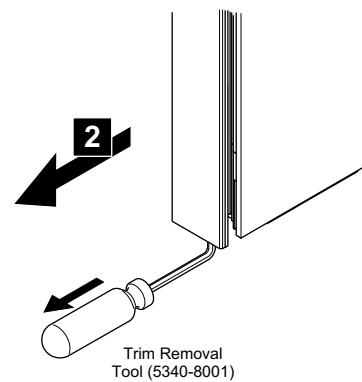

HORIZONTAL WITH 1 FTU

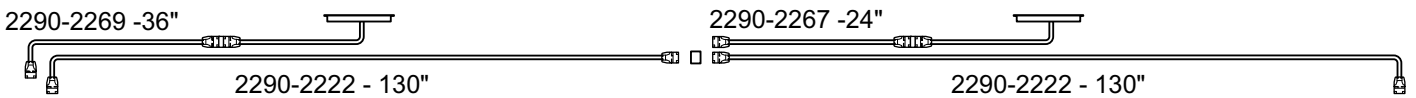
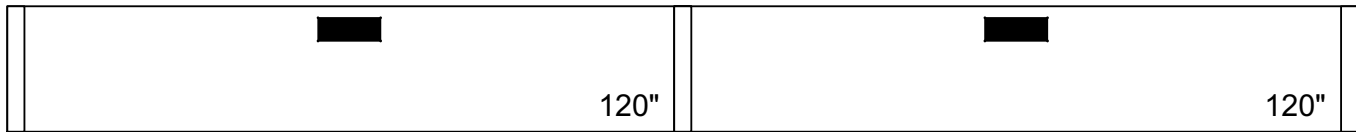
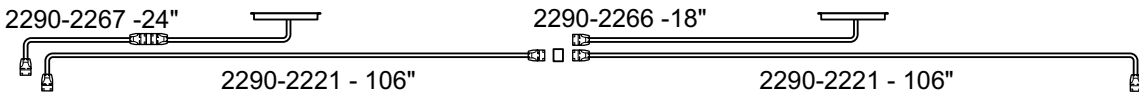
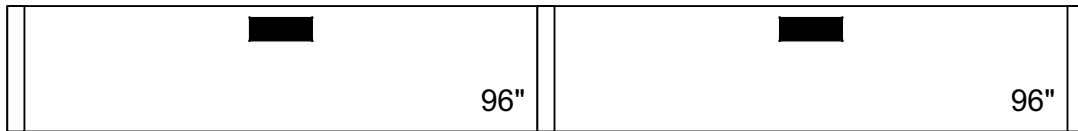
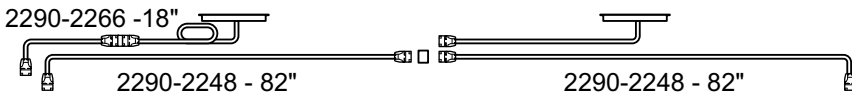
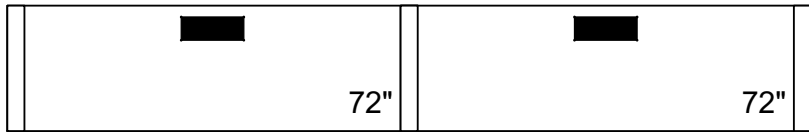
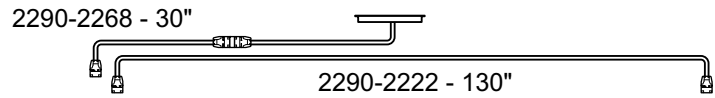
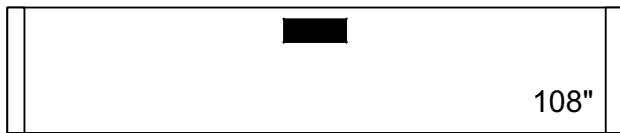
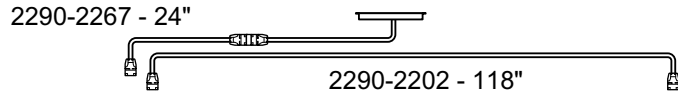
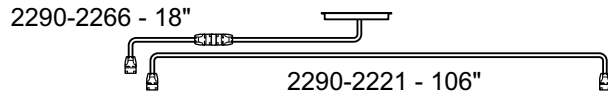
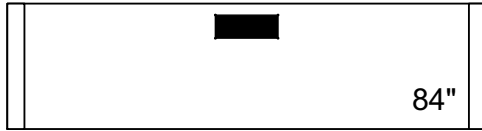
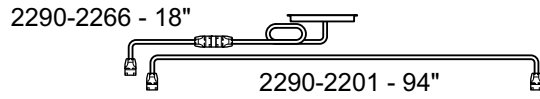
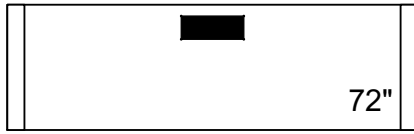
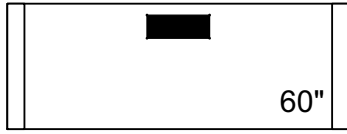
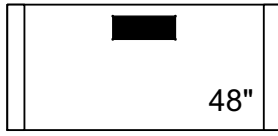

CUSTOMER SERVICE PHONE: 1-800-426-8562

HORIZONTAL WITH 2 FTU

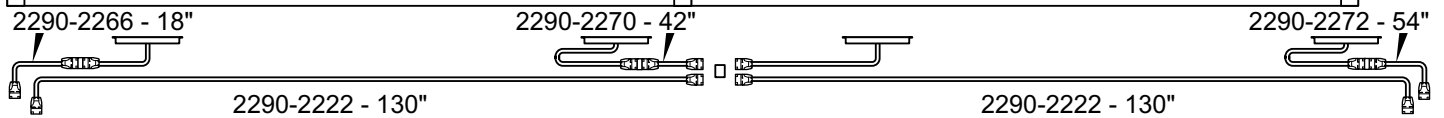
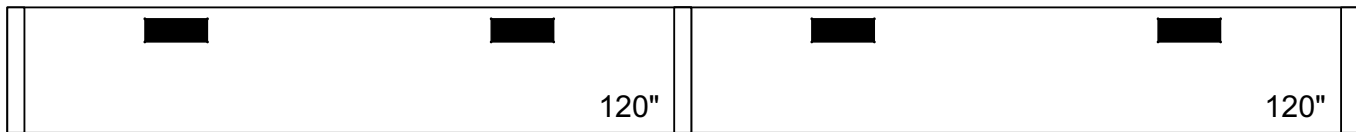
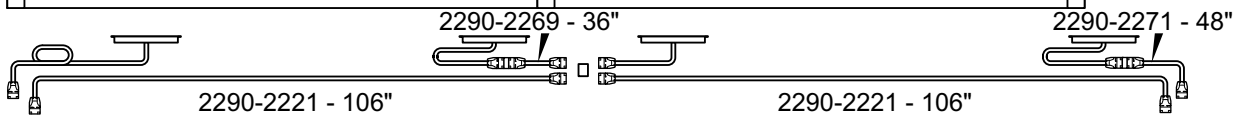
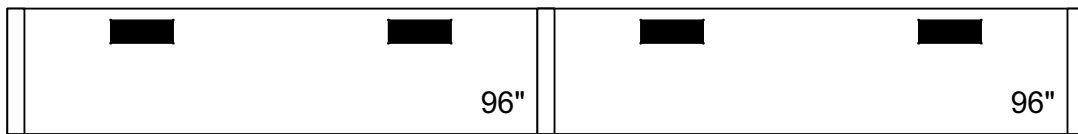
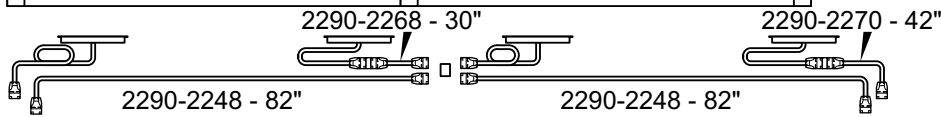
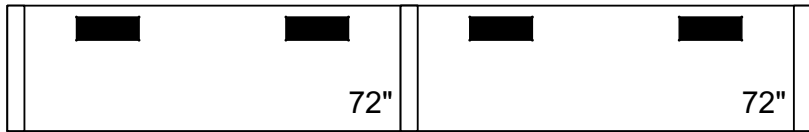
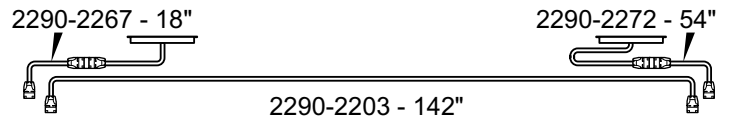
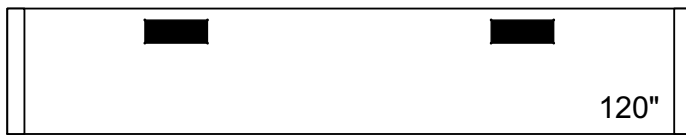
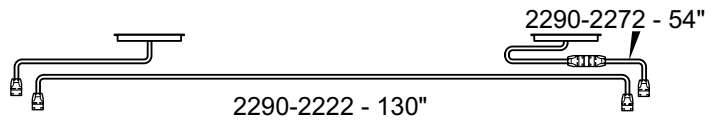
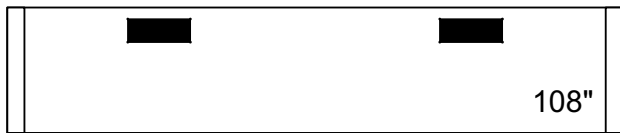
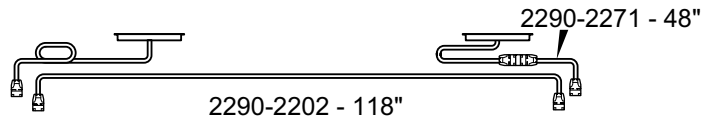
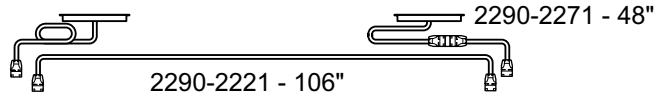
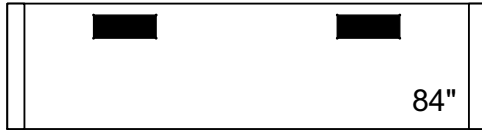
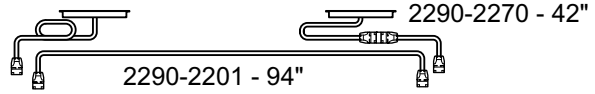
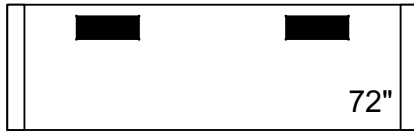
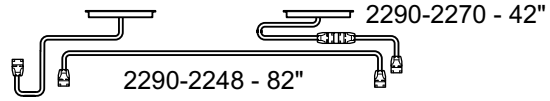
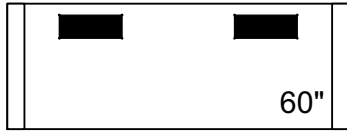
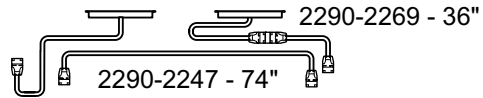
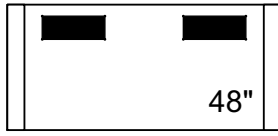

CUSTOMER SERVICE PHONE: 1-800-426-8562