

**REPAIR KIT FOR ACCOLADE CHAIR BACK
(HIGH, MID-HIGH, AND SLED BASE CHAIRS)
Installation Instructions**

Tools required

Standard (off the shelf) hot glue gun.

IMPORTANT! If any boss has more than **one** prong broken off, replace the shell, do not repair it.

1. Apply hot melt glue in cavity of damaged prong(s).
2. Firmly insert 1-1/4" tube provided, into prong cavity.
3. After glue is set, re-attach outer back to chair.

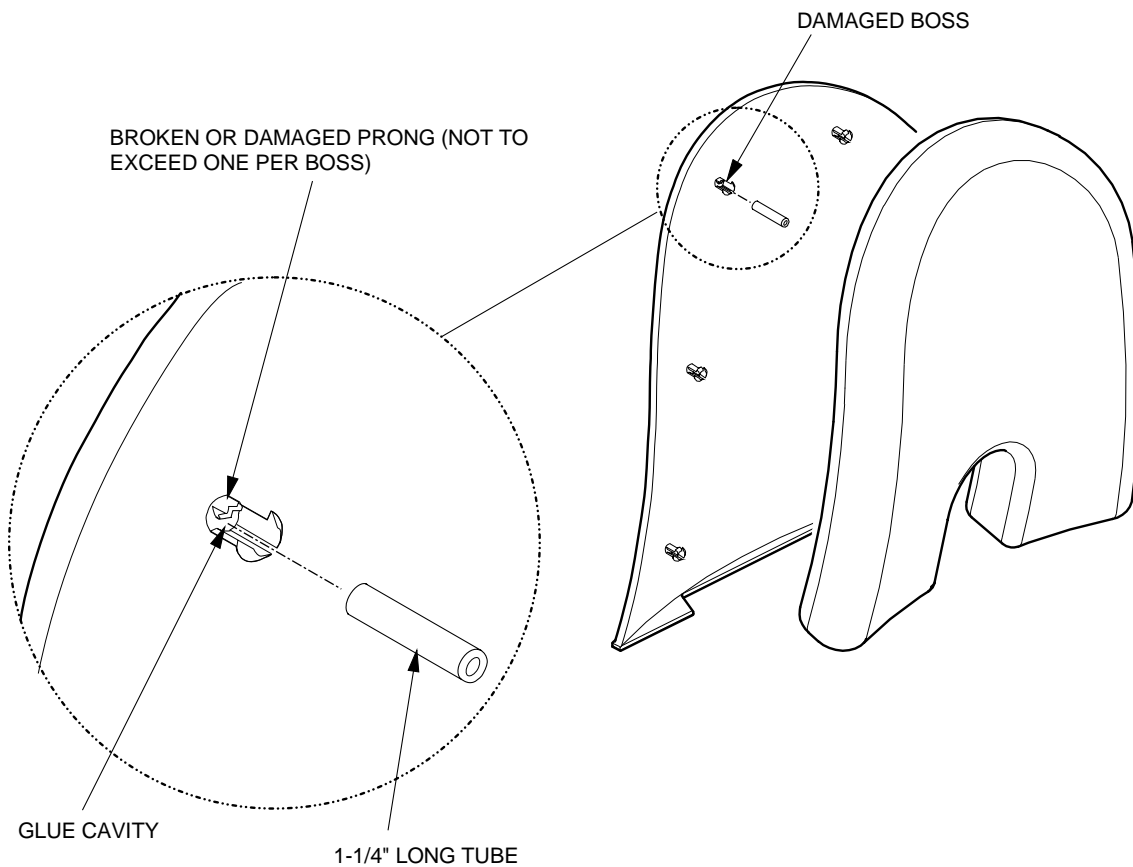

CUSTOMER SERVICE PHONE: 1-800-426-8562

HAWORTH

E.C.O. No: 205-409B

Page: 1 OF 1

Part No: 7021-6871

Rev. A