

A-SERIES®
Common Components
Installation Instructions

Tools Required

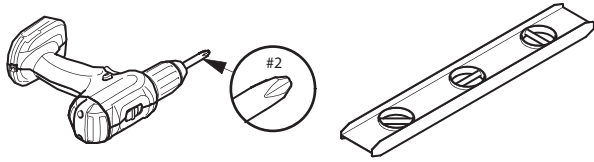

Open Casegood

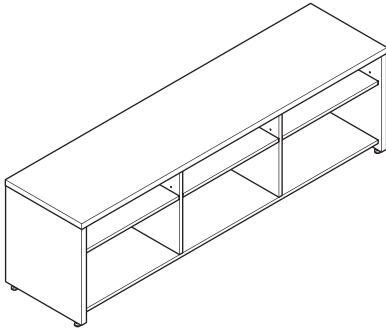

Casegood with Doors

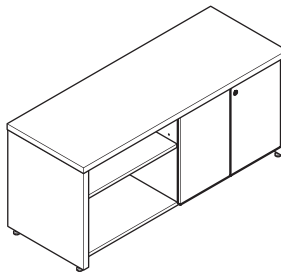

Casegood with Drawers

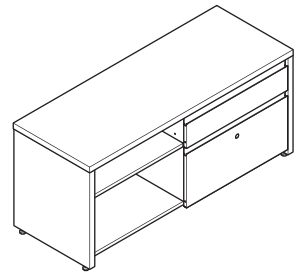

ADJUST GLIDES TO LEVEL UNIT

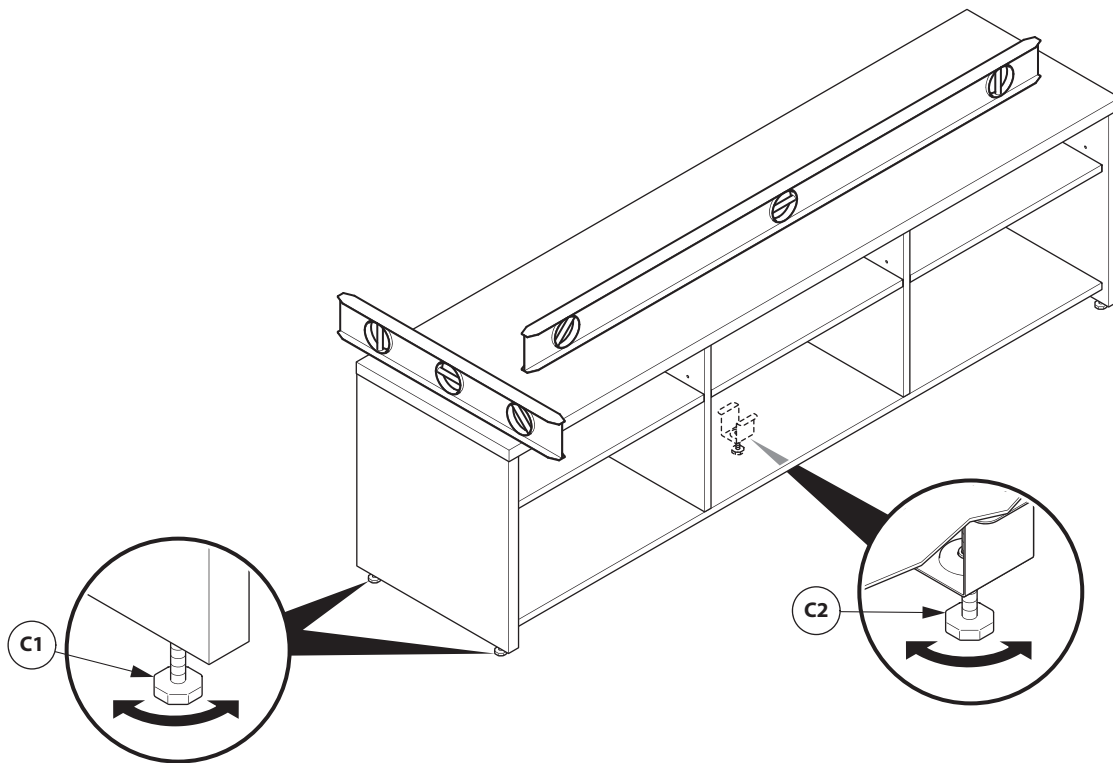

CUSTOMER SERVICE PHONE: 1-800-426-8562

HAWORTH®

E.C.O. No: 350-922

Page: 1 of 2

Part No: 7029-9877

Rev: A

SHELF PIN

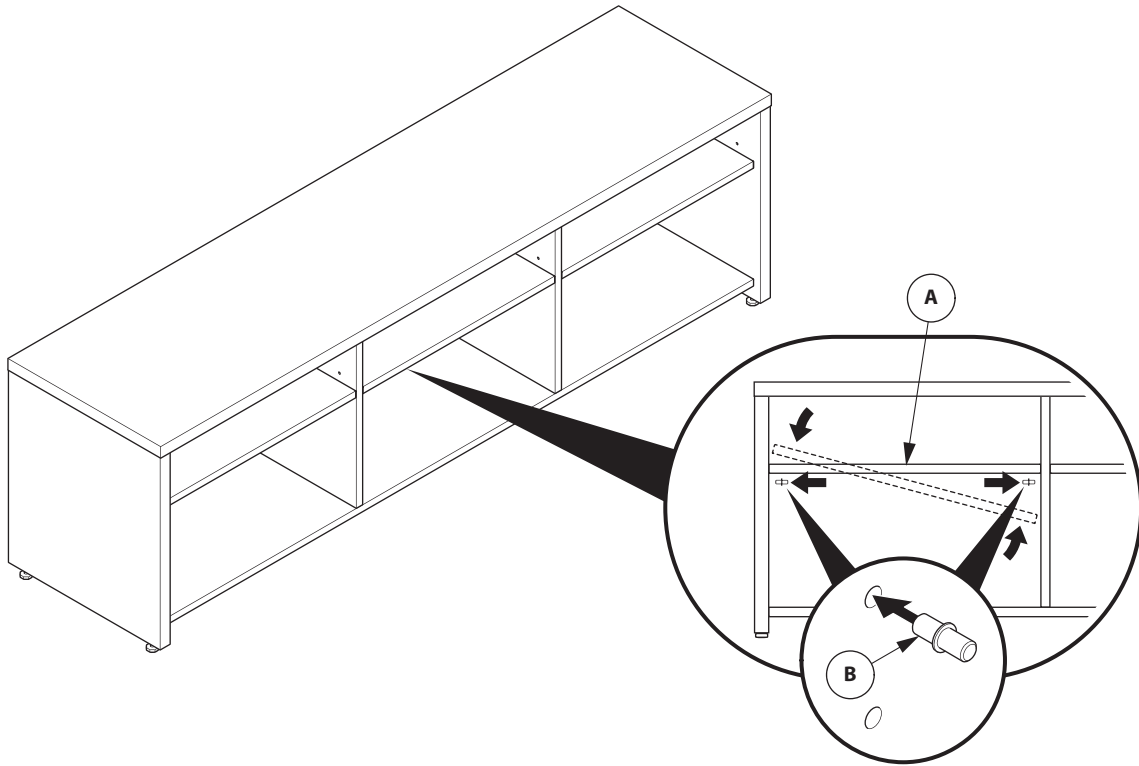

DOOR INSTALLATION/REMOVAL

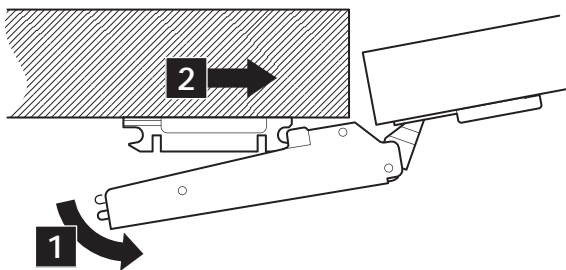

DOOR HINGE ADJUSTMENT

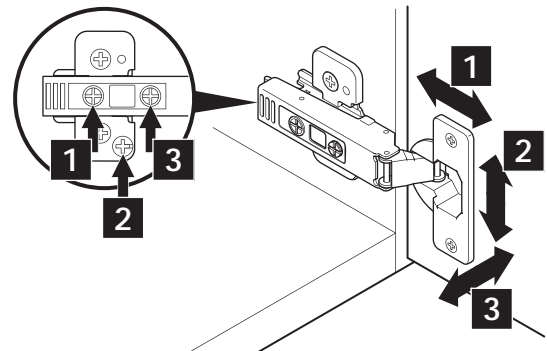

OPTIONAL LOCK PLUG INSTALLATION

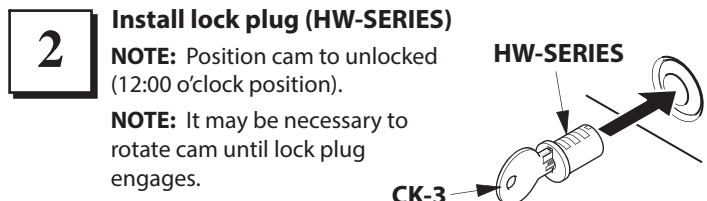
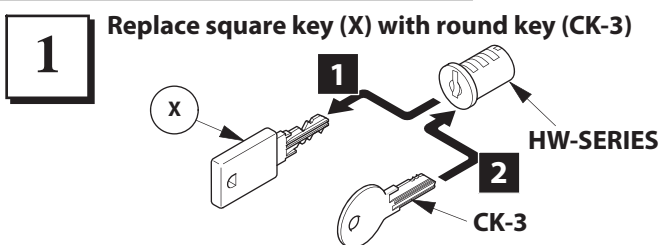

3 Remove round key (CK-3) and insert square key (X)

NOTE: Hold the lock plug (HW-SERIES) in place with thumb while removing the control key (CK-3).

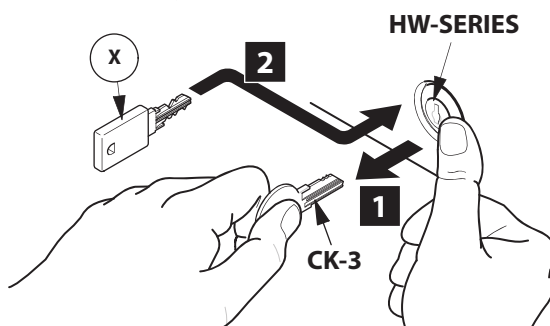

CUSTOMER SERVICE PHONE: 1-800-426-8562