

**BE\_HOLD™**  
**Legs - Single/Double/Triple**  
**Installation Instructions**

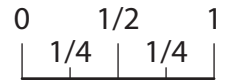

**Scale 1 : 1**

**Tools Required**

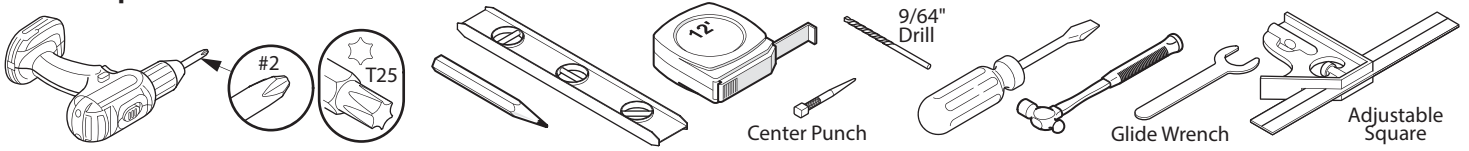

**LEGS - SINGLE CABINET**

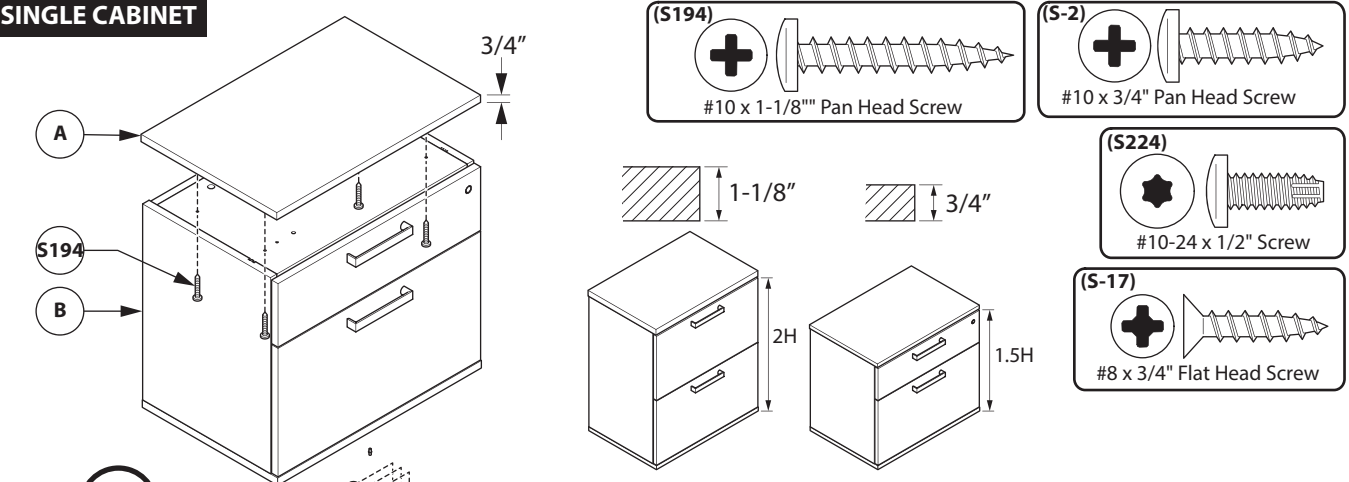

**LEGS - DOUBLE CABINET**

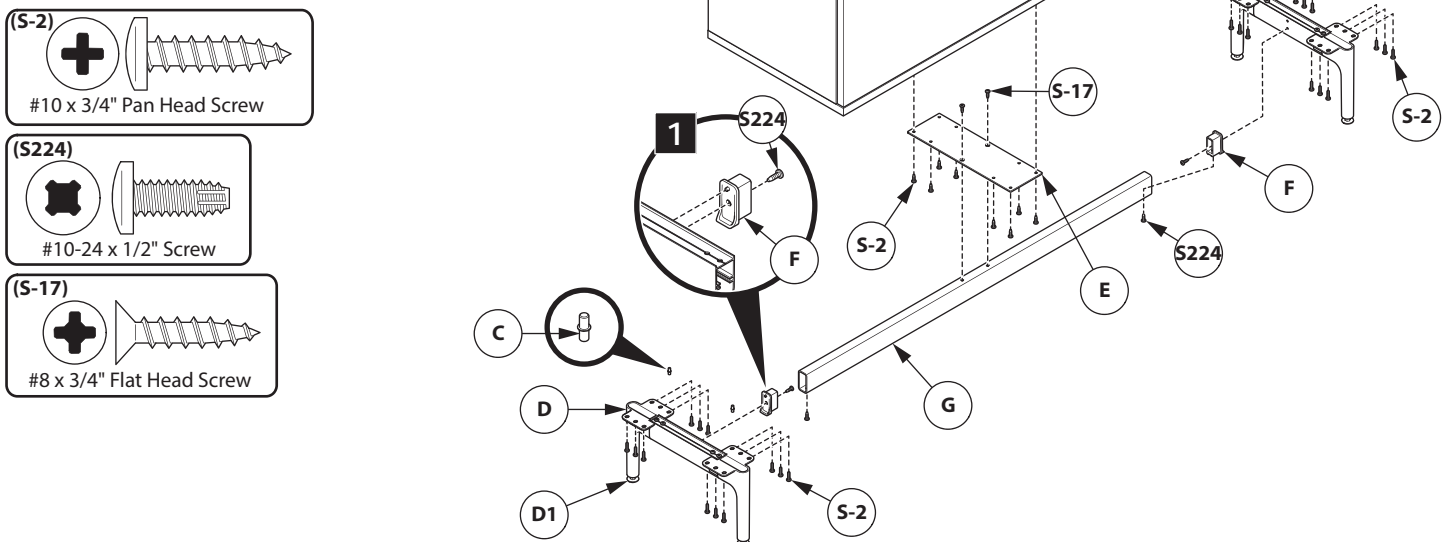

CUSTOMER SERVICE PHONE: 1-800-426-8562

**LEGS - TRIPLE CABINET**

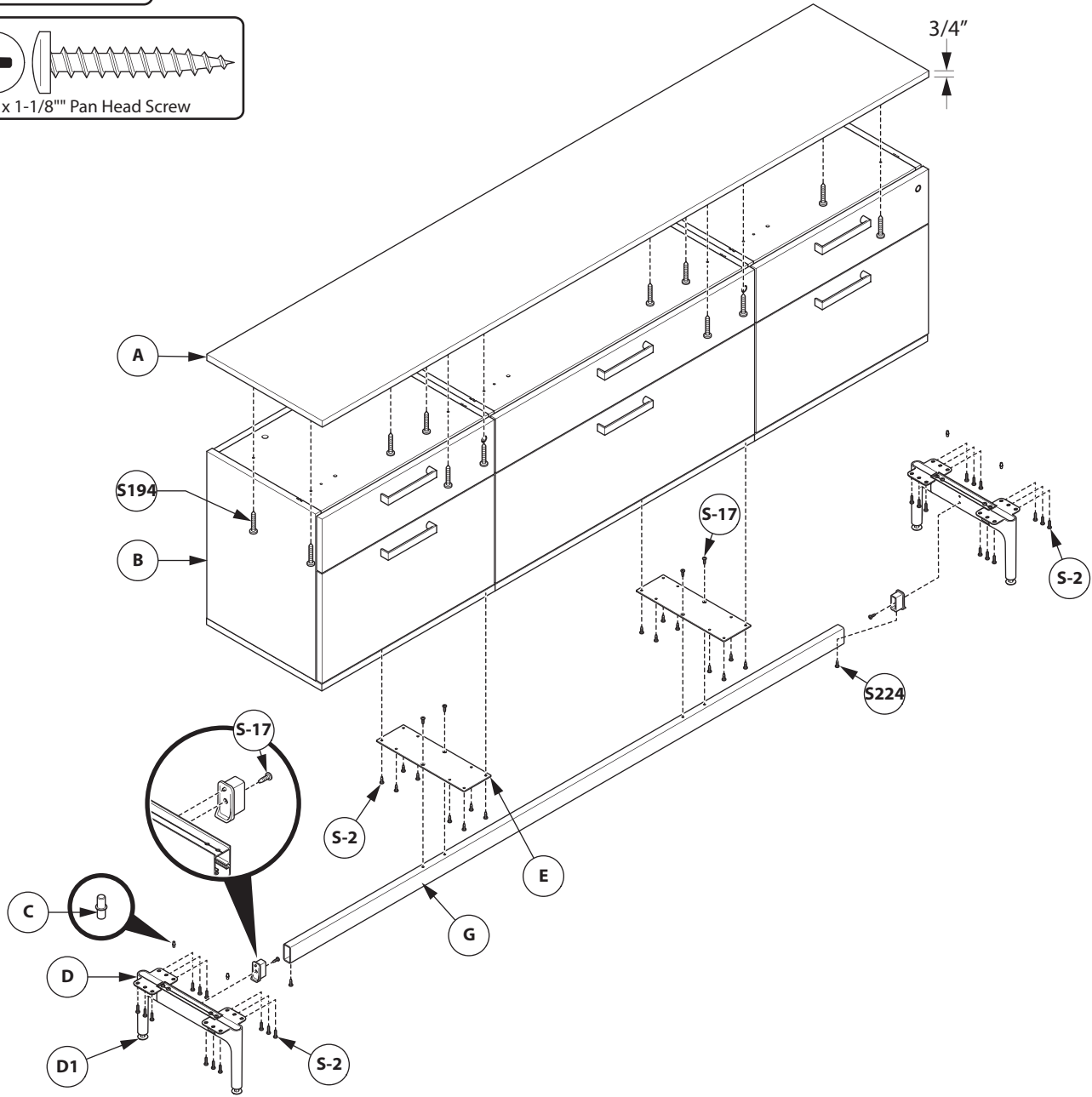
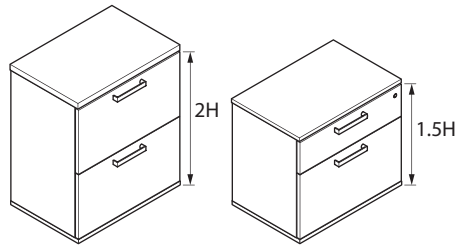
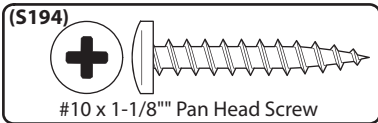
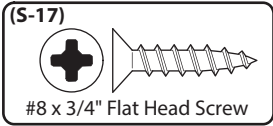
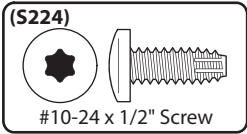
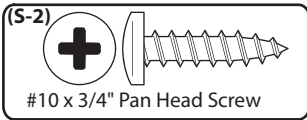
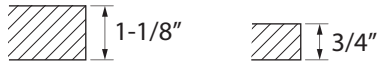

CUSTOMER SERVICE PHONE: 1-800-426-8562

**HAWORTH**

E.C.O. No: 781-431

Page: 2 of 12

Part No: 6100-0134

Rev: 1

1

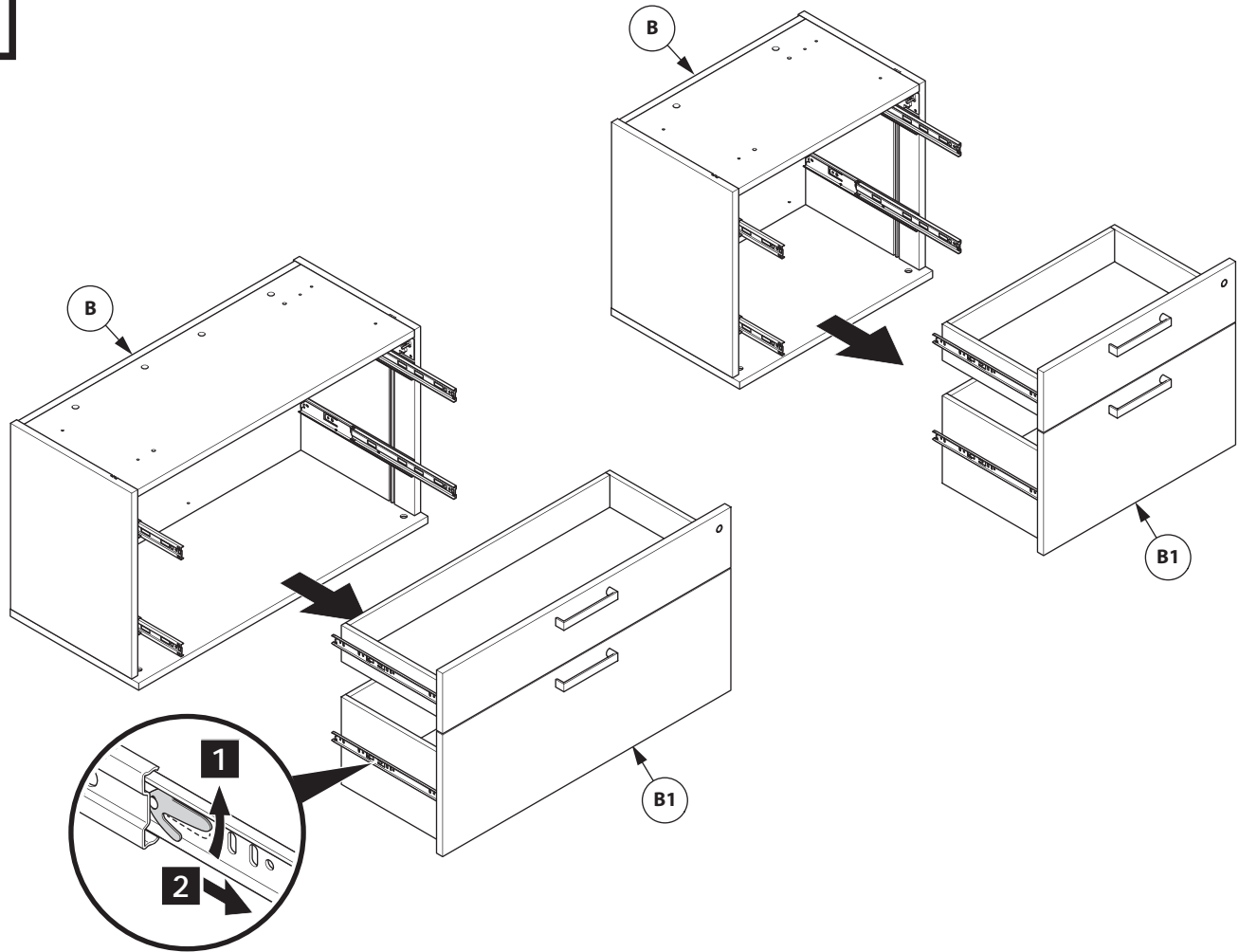

2

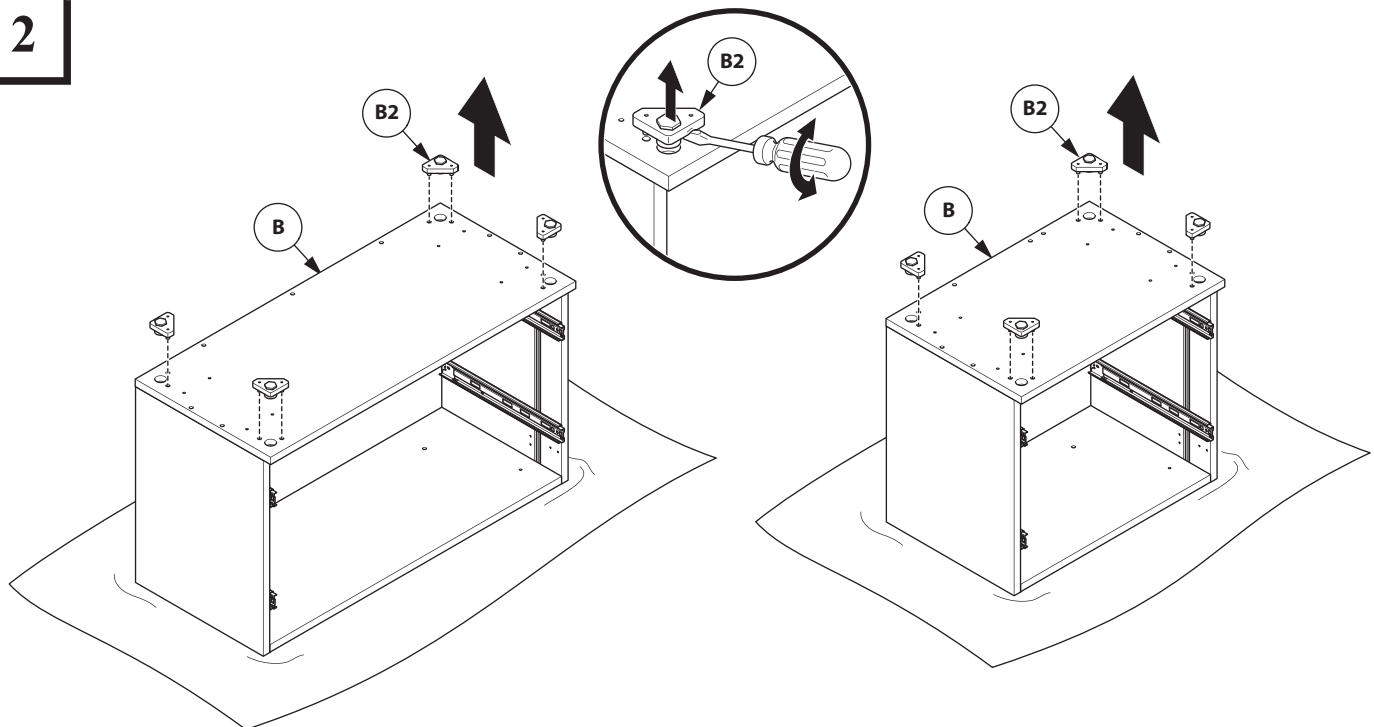

CUSTOMER SERVICE PHONE: 1-800-426-8562

**HAWORTH**

E.C.O. No: 781-431

Page: 3 of 12

Part No: 6100-0134

Rev: 1

3

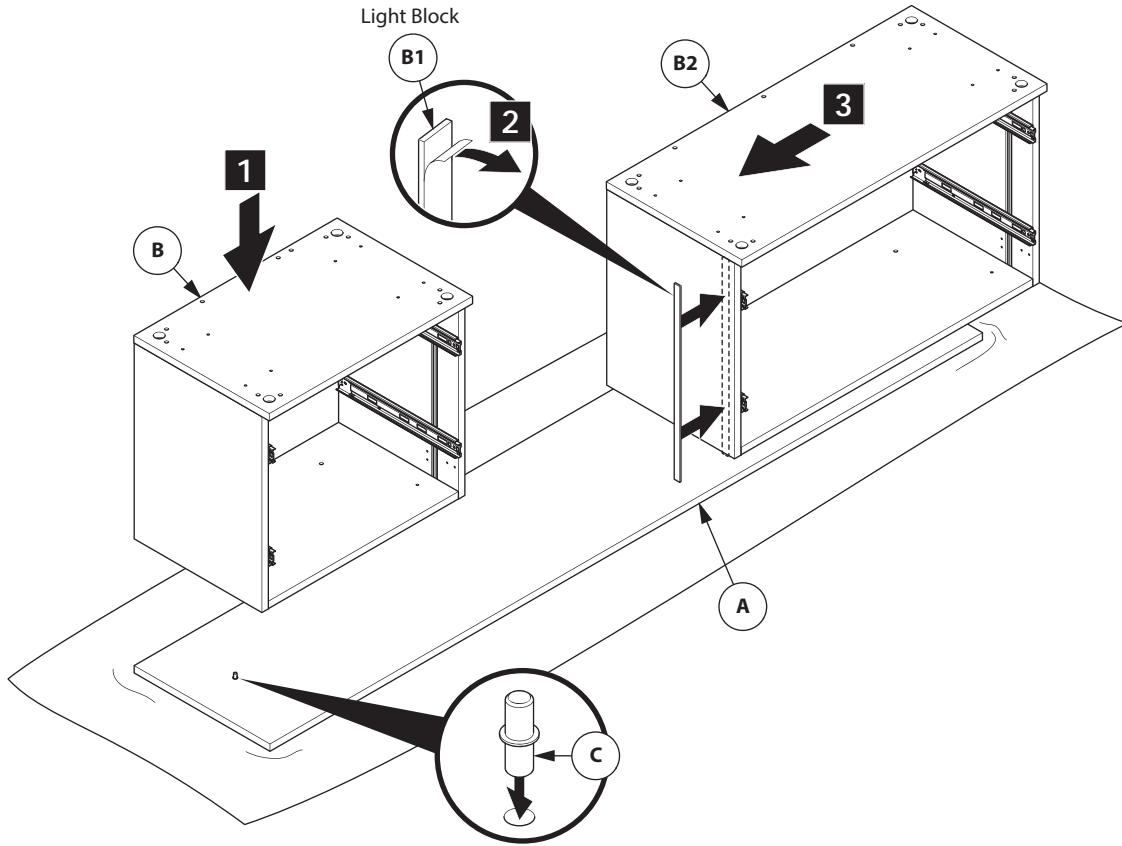

4

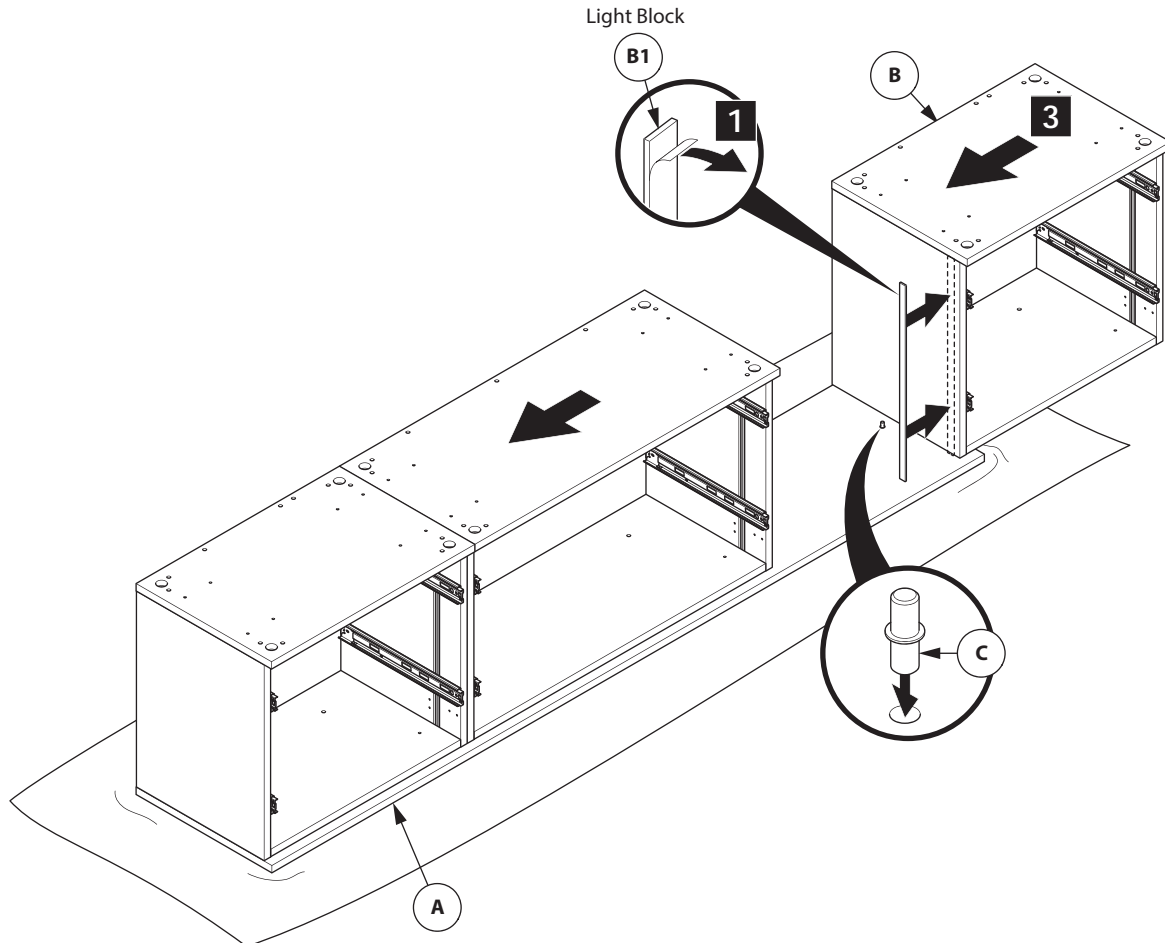

CUSTOMER SERVICE PHONE: 1-800-426-8562

**HAWORTH**

E.C.O. No: 781-431

Page: 4 of 12

Part No: 6100-0134

Rev: 1

5

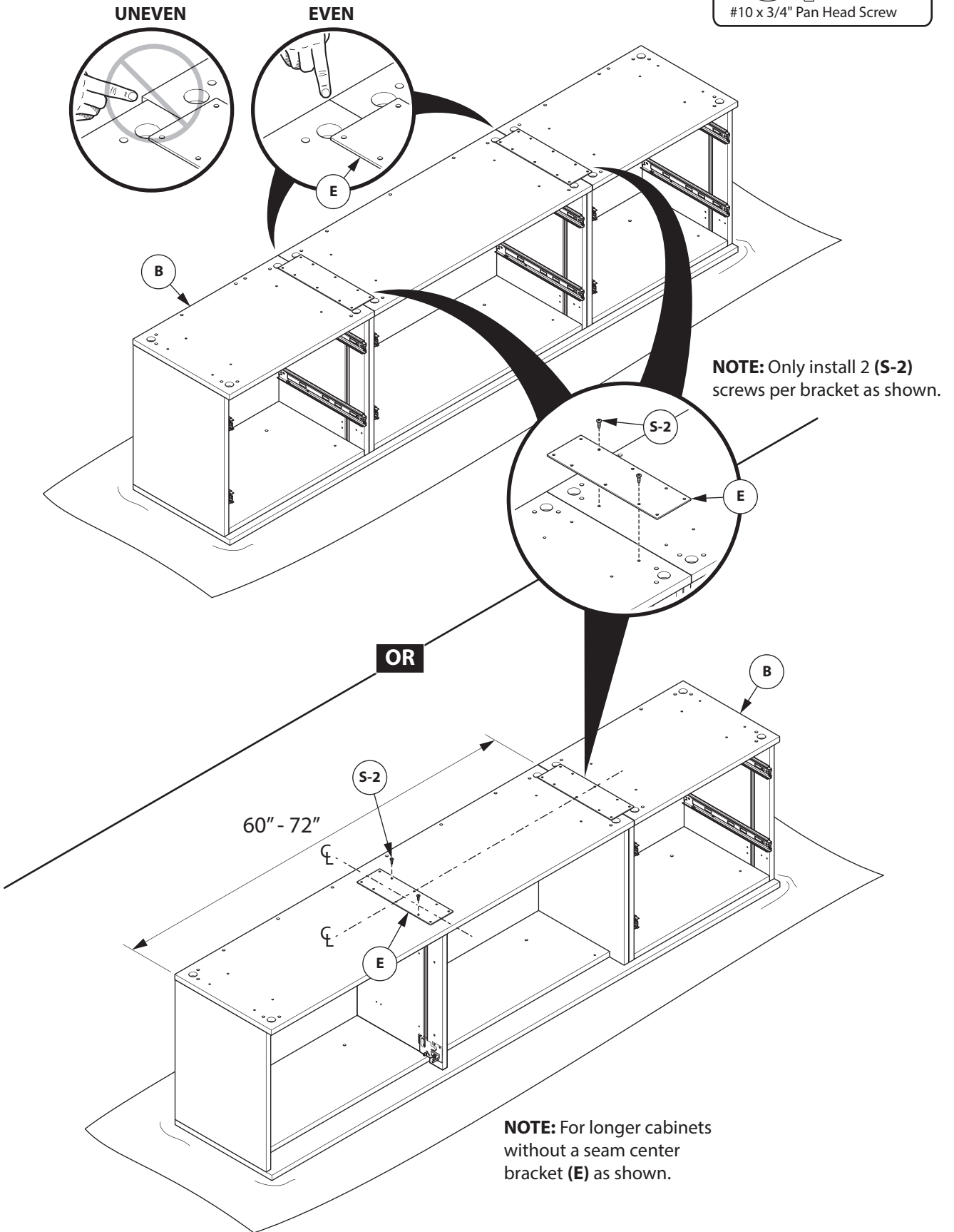
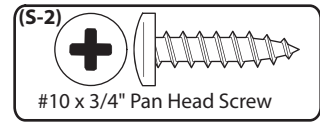

CUSTOMER SERVICE PHONE: 1-800-426-8562

**HAWORTH**

E.C.O. No: 781-431

Page: 5 of 12

Part No: 6100-0134

Rev: 1

6

(S224)

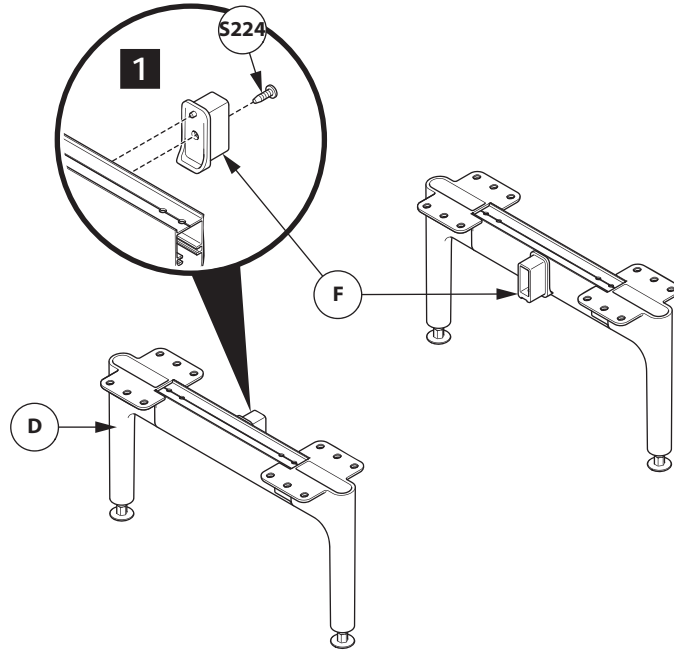
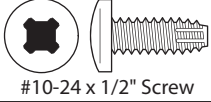

7

**NOTE: DO NOT** install screws in this step.

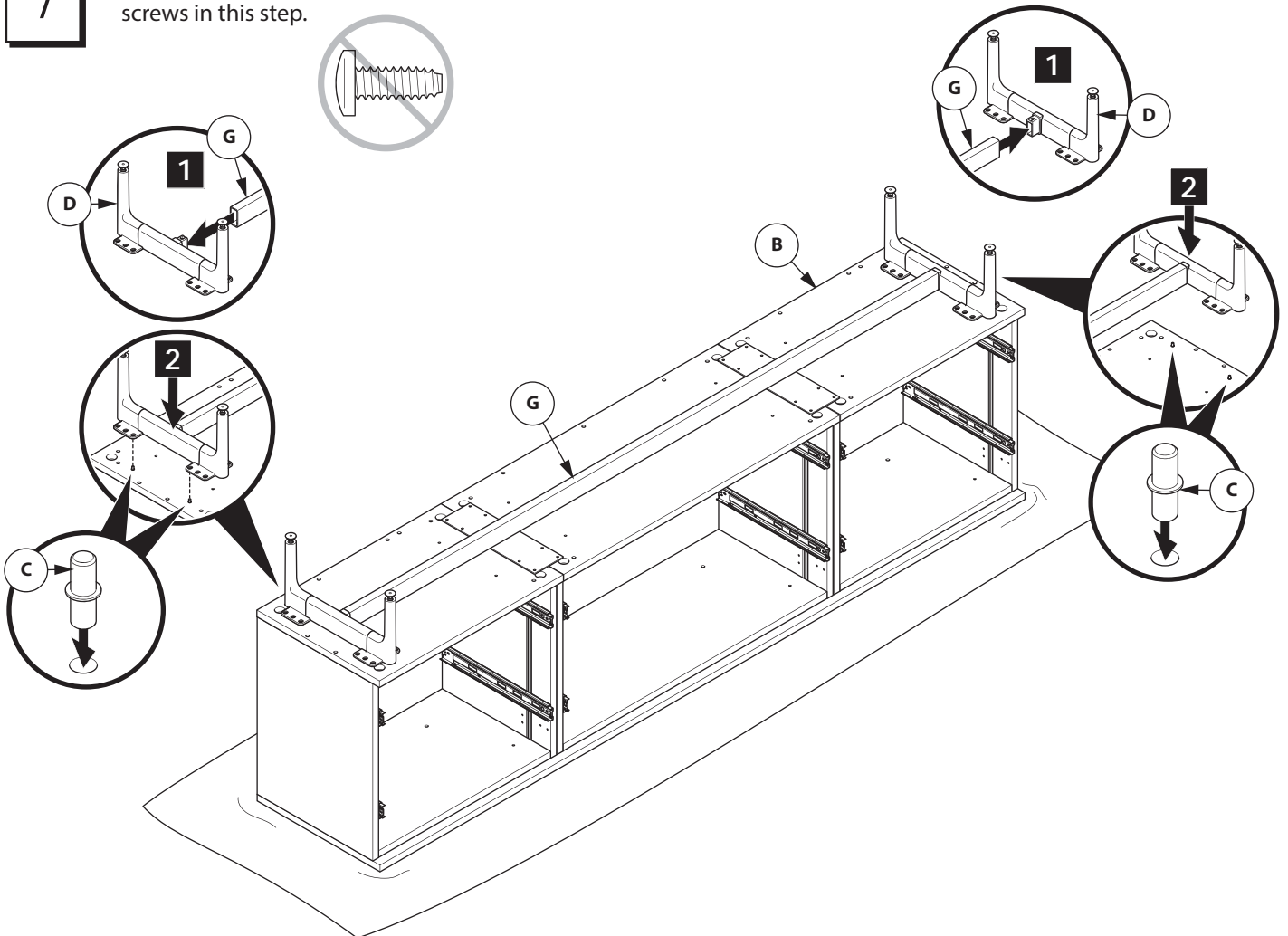
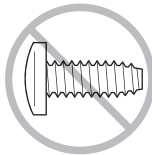

CUSTOMER SERVICE PHONE: 1-800-426-8562

**HAWORTH**

E.C.O. No: 781-431

Page: 6 of 12

Part No: 6100-0134

Rev: 1

8

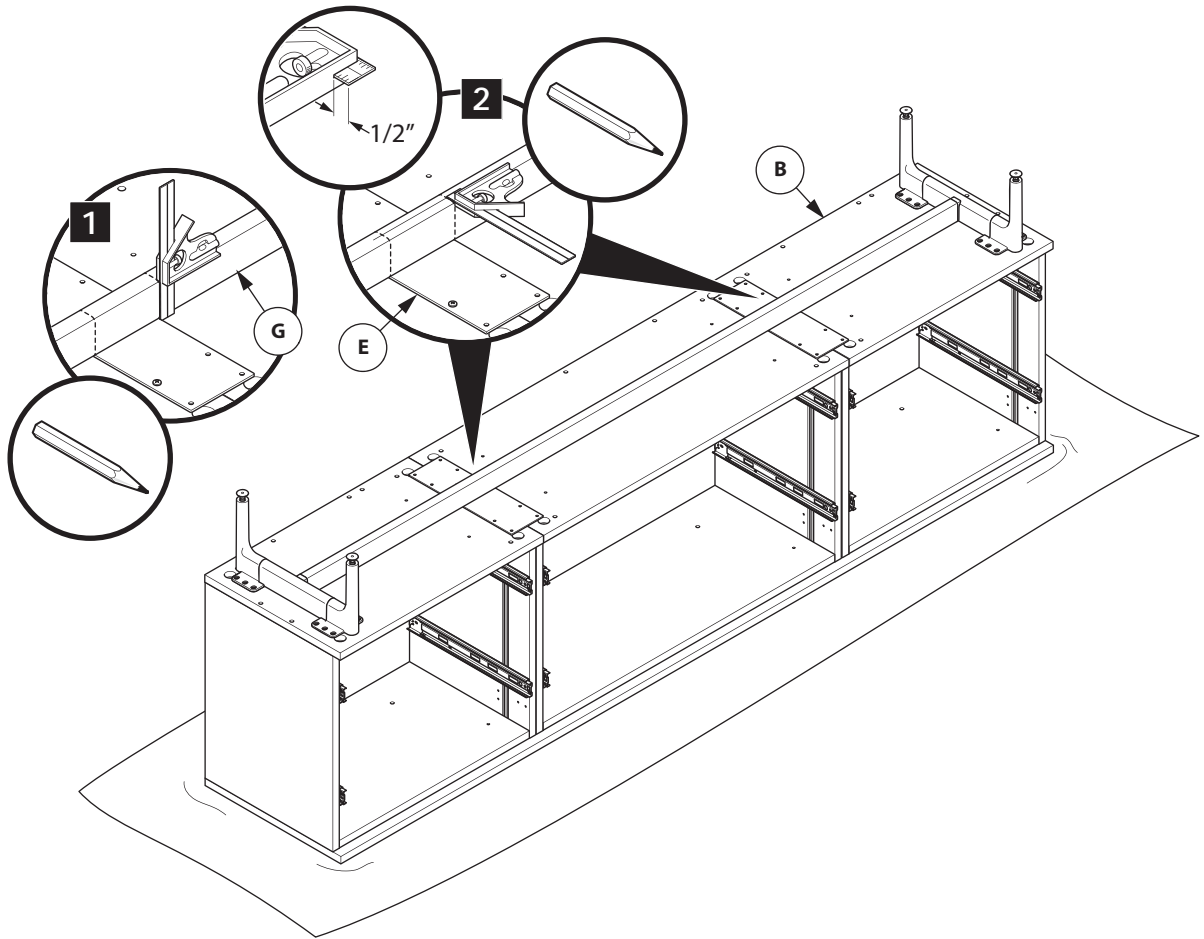

9

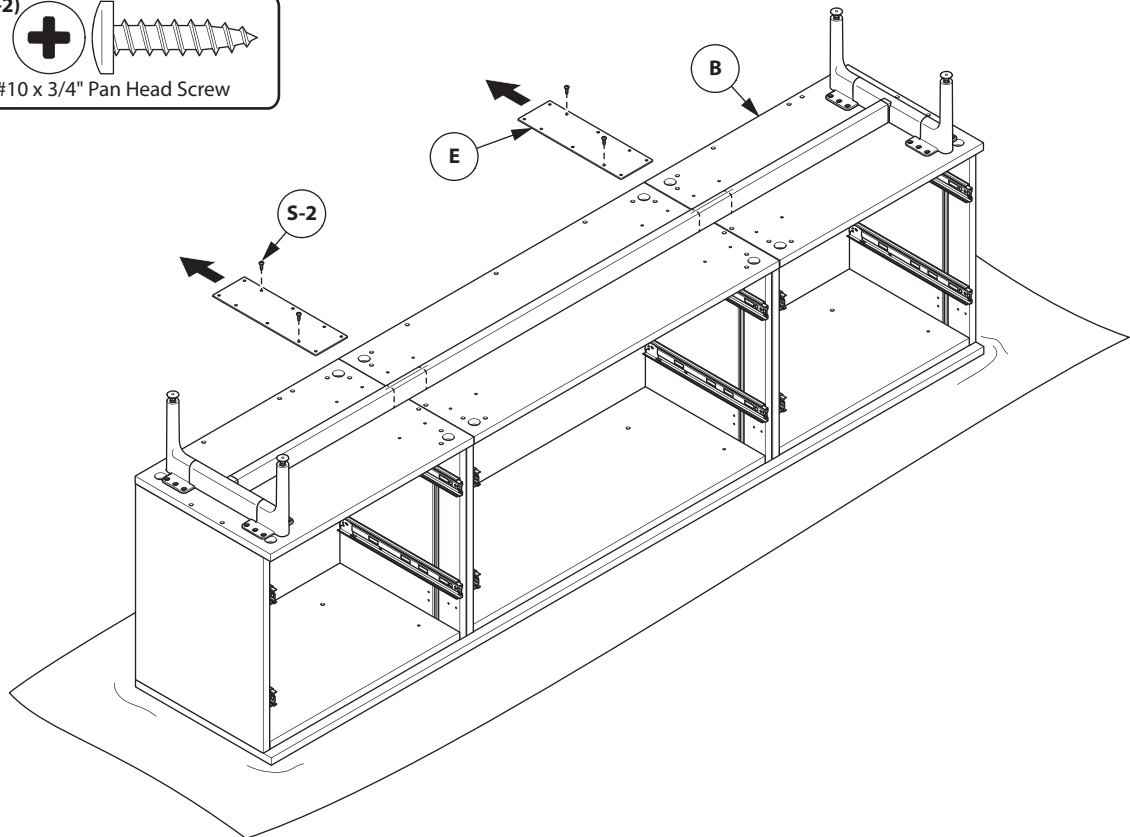
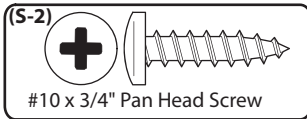

CUSTOMER SERVICE PHONE: 1-800-426-8562

**HAWORTH**

E.C.O. No: 781-431

Page: 7 of 12

Part No: 6100-0134

Rev: 1

10

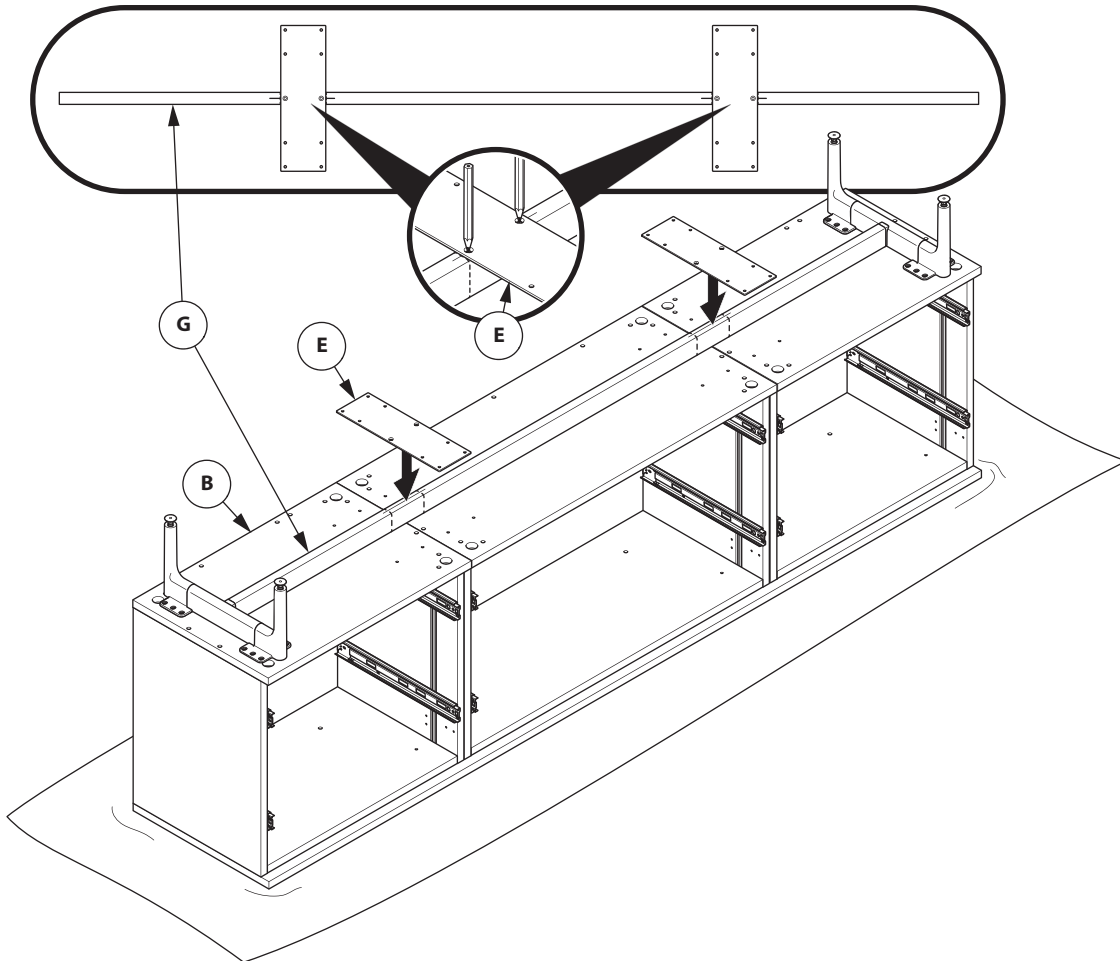

11

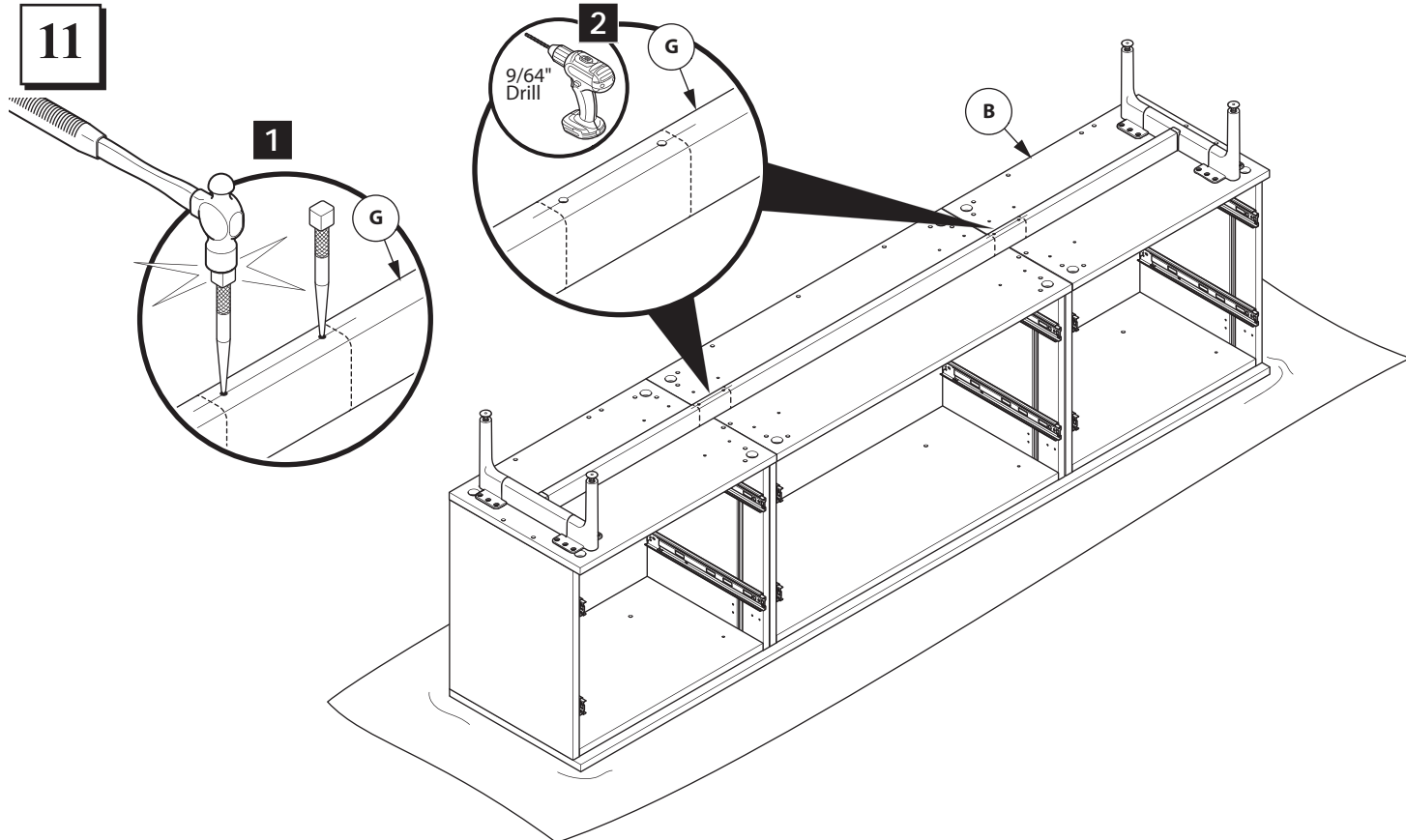

CUSTOMER SERVICE PHONE: 1-800-426-8562

**HAWORTH**

E.C.O. No: 781-431

Page: 8 of 12

Part No: 6100-0134

Rev: 1



12

NOTE: Screw (S-17) must be flush.

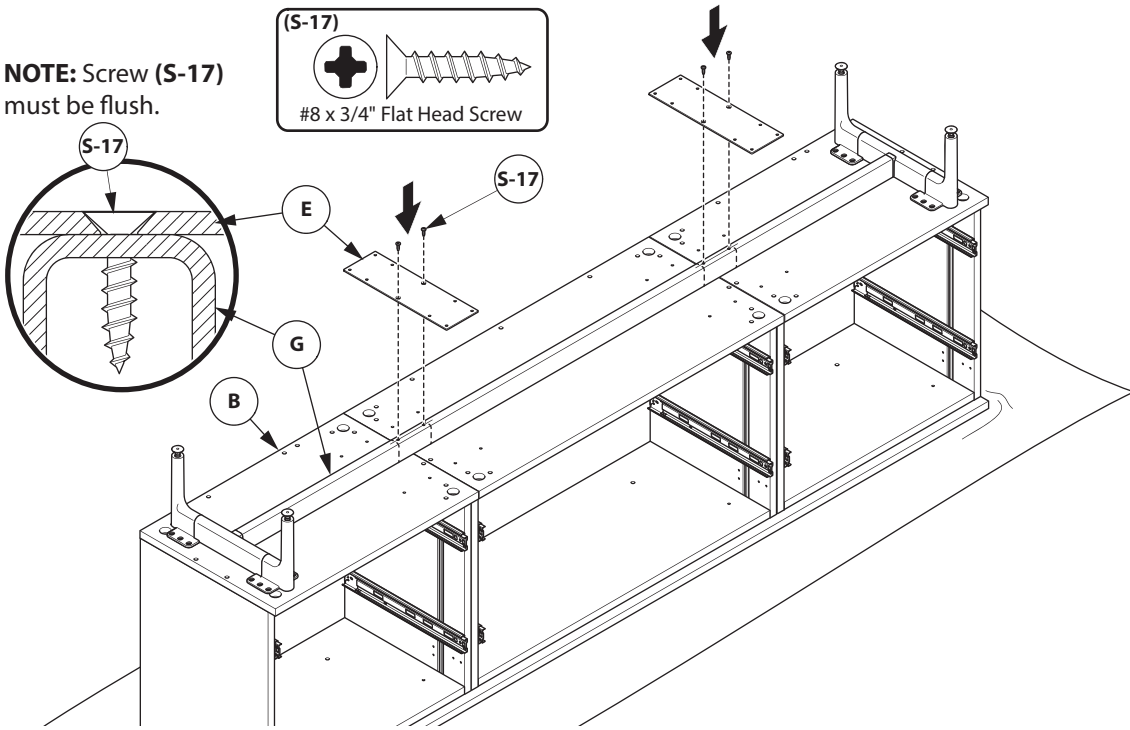
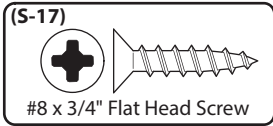

13

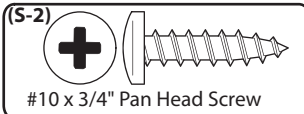

UNEVEN

EVEN

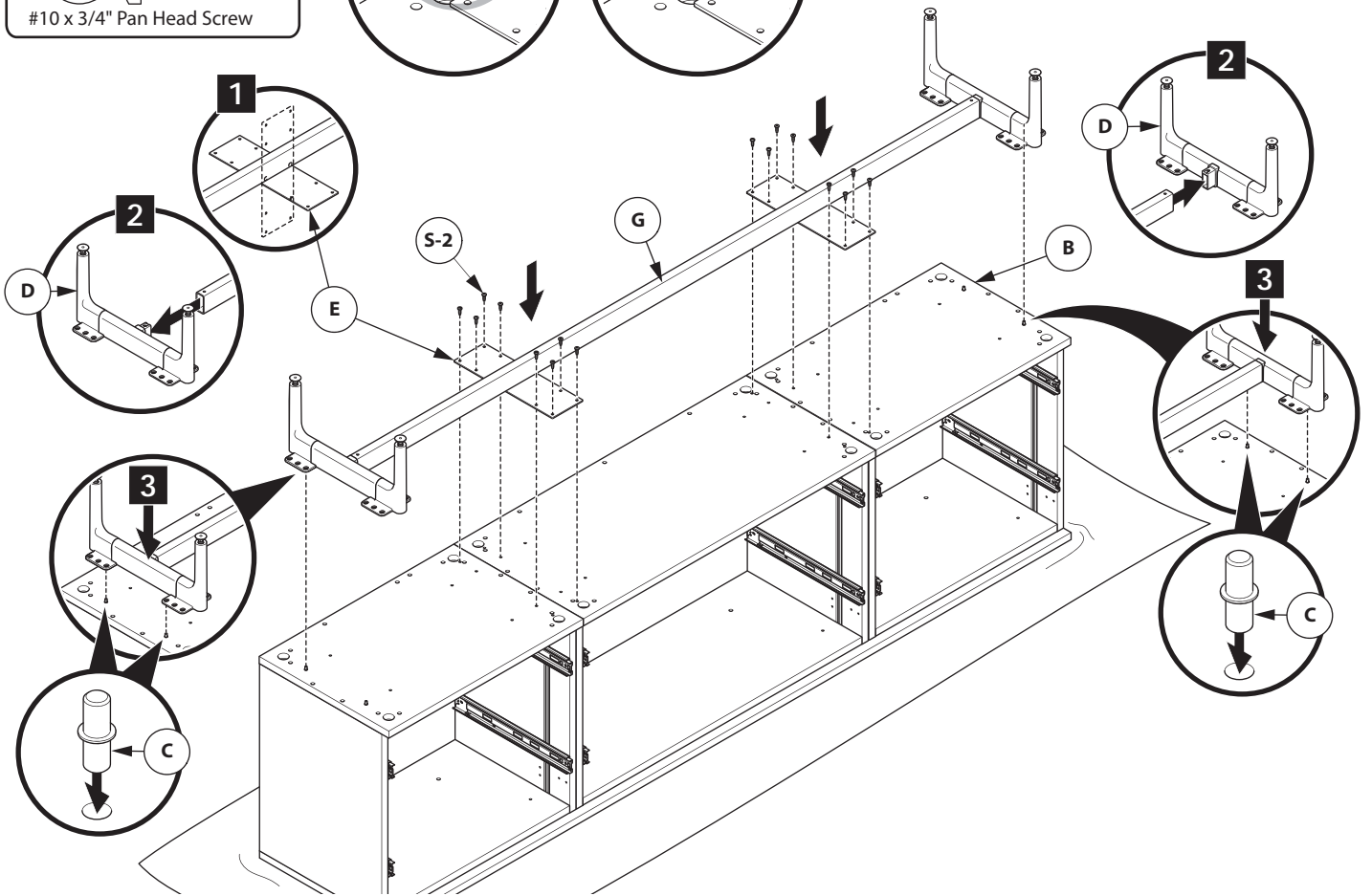

CUSTOMER SERVICE PHONE: 1-800-426-8562

**HAWORTH**

E.C.O. No: 781-431

Page: 9 of 12

Part No: 6100-0134

Rev: 1

14

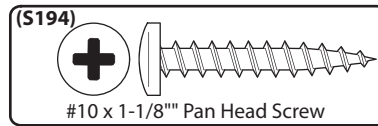
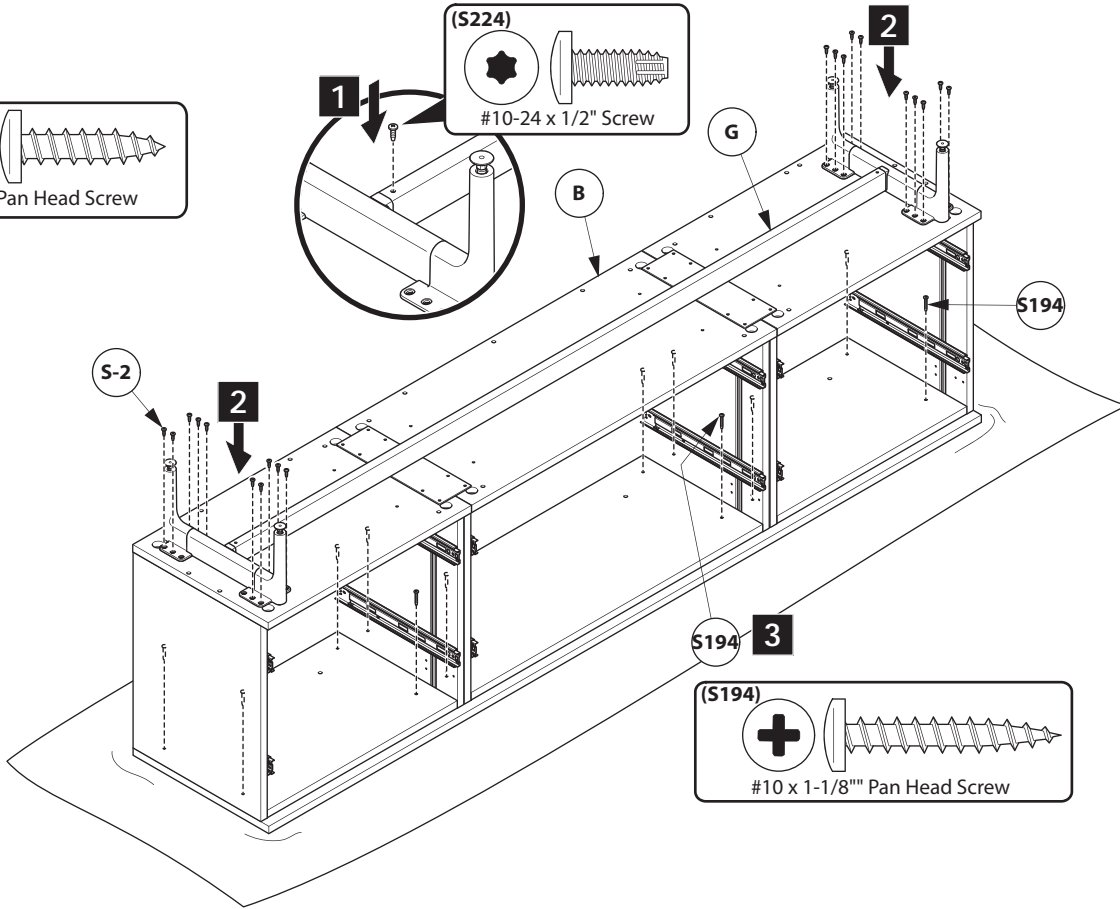
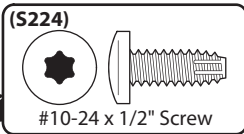
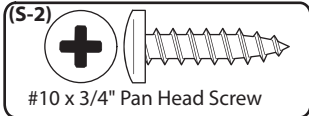

15

**! IMPORTANT!**

**DO NOT ROTATE CASE ON LEGS. LIFT CASE, THEN ROTATE AND PLACE.**

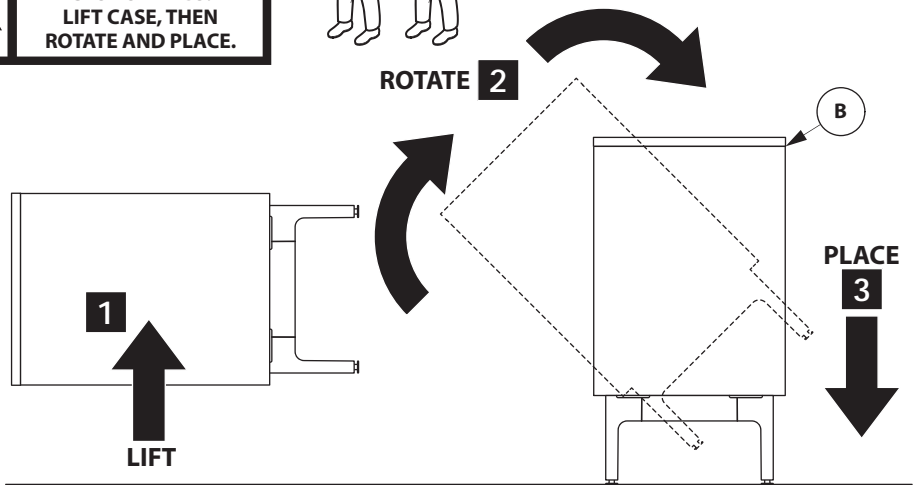
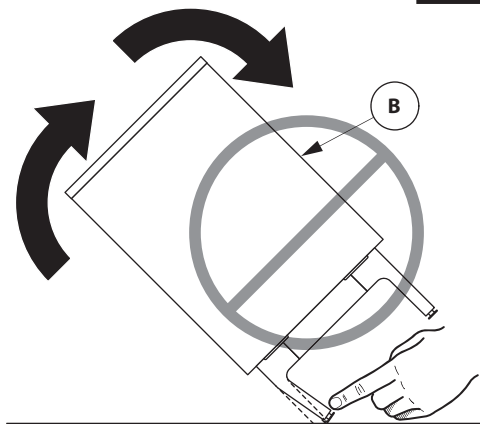
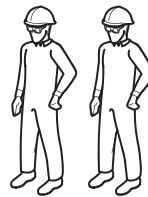

CUSTOMER SERVICE PHONE: 1-800-426-8562

**HAWORTH**

E.C.O. No: 781-431

Page: 10 of 12

Part No: 6100-0134

Rev: 1

16

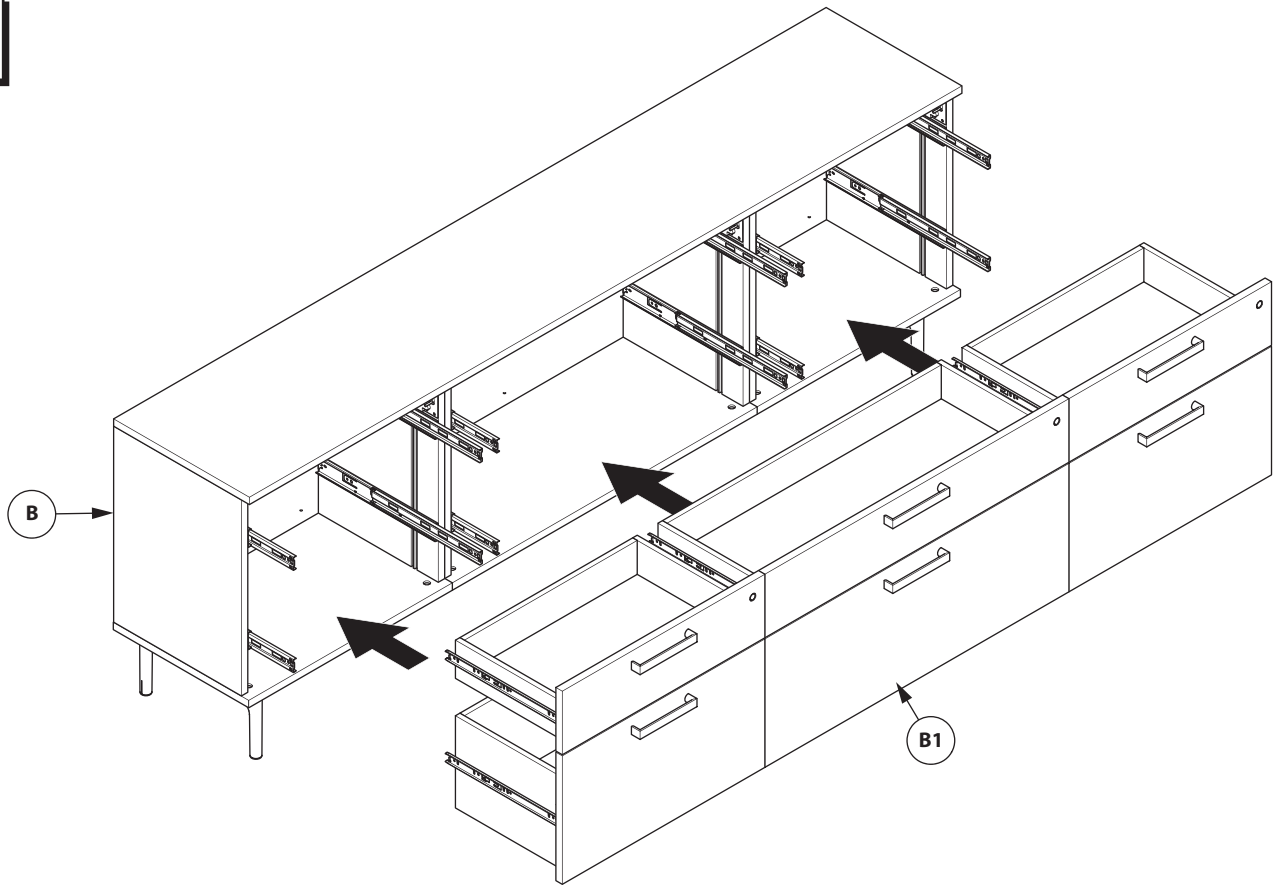

17

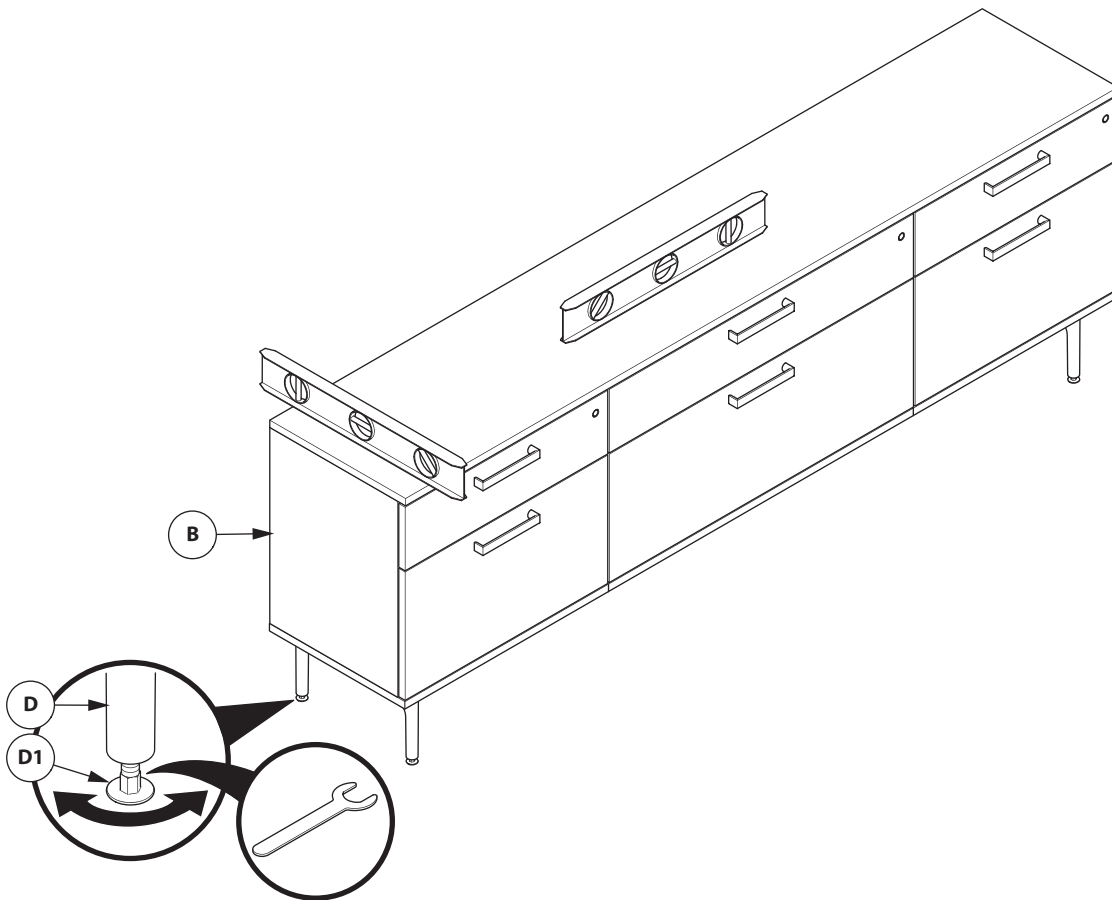

CUSTOMER SERVICE PHONE: 1-800-426-8562

**HAWORTH**

E.C.O. No: 781-431

Page: 11 of 12

Part No: 6100-0134

Rev: 1

**PULL INSTALLATION**

**1**

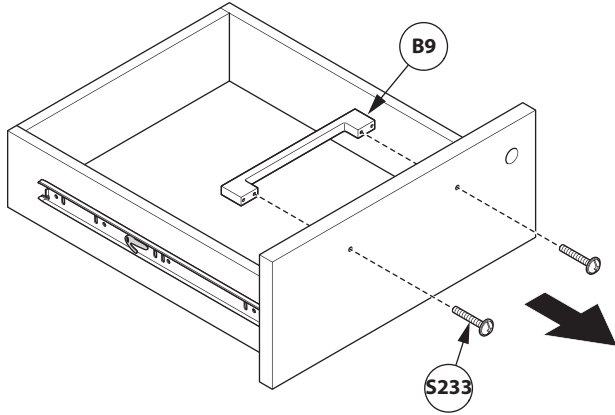
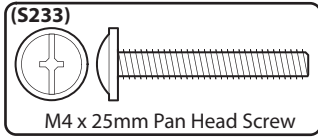

**2**

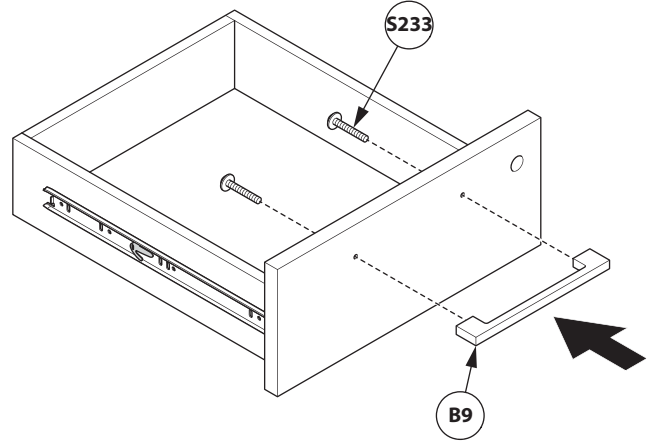

**DOOR HINGE INSTALLATION/REMOVAL**

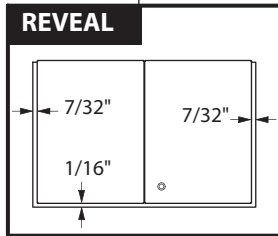
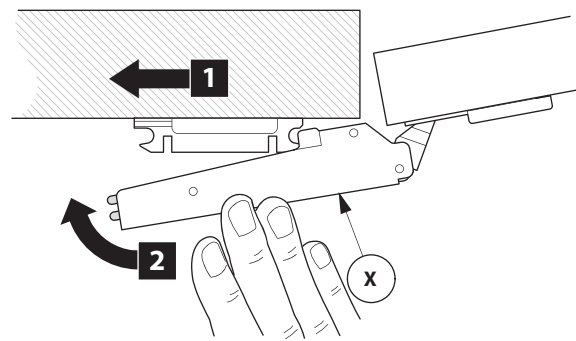

**DOOR HINGE ADJUSTMENT**

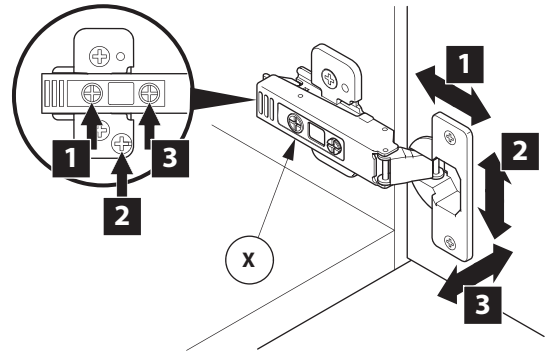

**OPTIONAL: LOCK PLUG INSTALLATION**

**1**

Replace square key (R1) with round key (R2)

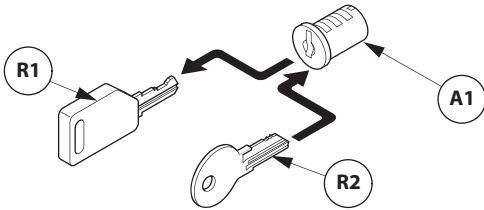

**2**

Install lock plug (A1)

**NOTE:** Position cam to unlocked (9:00 o'clock) position.  
**NOTE:** It may be necessary to rotate cam until lock plug engages.

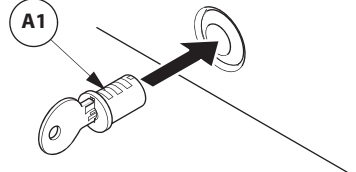

**3**

Remove round key (R2) and insert square key (R1)

**NOTE:** Hold the lock plug (A1) in place with thumb while removing the control key (R2).

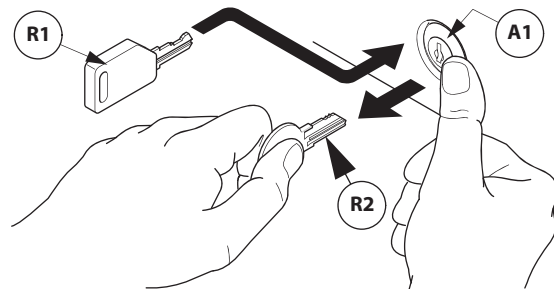

CUSTOMER SERVICE PHONE: 1-800-426-8562